

	Transport Canada
Design Approval Representative No. 326	
APPROVED	
By	
Date	2021-10-05
For	
Appr'l No.	SH21-38
Issue No.	1
YY-MM-DD	

CABIN FLOOR PROTECTION, KIT INSTALLATION INSTRUCTIONS

MODELS: BELL 505

Table of Contents

<u>Section</u>	<u>Description</u>	<u>Page</u>
1	Description	2
2	Installation Instructions Cabin Floor Protection, Kit	
	3	
	Applicability	3
	Installation Instructions AFT Cabin Floor Protection, Kit – AAL-312-060-001	4
	Removal Instructions	6
	Installation Instructions FWD Floor Protection Panel, Kit – AAL-312-060-002	7
	Removal Instructions	9

Notes

1. If changes to this document are required, Alpine Aerotech LP shall revise all pages and reissue the entire document.
2. Alpine Aerotech LP shall make any subsequent revisions of this document available free of charge upon request. Alpine Aerotech LP also recommends that the end user of this product periodically verify the revision level of this document.

SECTION 1 DESCRIPTION

The following information provides installation instructions for the Cabin Floor Protection, Kit as defined in Alpine Aerotech LP datasets AAL-312-060-901.

- The Cabin Floor Protection, Kit includes rigid pieces of material that are installed atop the existing floor to protect it from dents and punctures associated with typical aircraft usage. This occurs most frequently during loading and unloading operations, but can also occur during small inflight shifts of said cargo.
- The Cabin Floor Protection, Kit when installed, adds additional protection to the floor panels, as it is manufactured from a material specifically designed to spread and attenuate energy.

SECTION 2 INSTALLATION & REMOVAL INSTRUCTIONS

Applicability

The Cabin Floor Protection, Kit (AAL-312-060-901) is applicable to all serial numbers of Bell 505 rotorcraft with OEM interiors.

Weight & Balance

<u>Part Number</u>	<u>Description</u>	<u>Weight</u>	<u>Long. Arm</u>	<u>Lat. Arm</u>
AAL-312-060-901	Cabin Floor Protection, Kit	11.67* 5.29 (Kg)	117.14 (STA) 2.975 (m)	0.49 (BL) 0.012 (m)
AAL-312-060-001	AFT Cabin Floor Protection, Kit	9.62* 4.36 (Kg)	122.83 (STA) 3.119 (m)	0.58(BL) 0.014 (m)
AAL-312-060-002	FWD Floor Protection Panel, Kit	2.06* 0.93 (Kg)	90.49 (STA) 2.298 (m)	0.00 (BL) 0.000 (m)

* Represents total weight of applicable kit only. Recalculate C of G as appropriate.

General Notes

1. All Installation Instructions shall be accomplished IAW standard aircraft practices. Refer to the current revision of the FAA publications AC 43.13-1B and AC 43.13-2B for details on standard aircraft practices.
2. All Dimensions are in imperial measures (inches/pounds).
3. Refer to Section 4: AAL-312-065-701 Maintenance Manual section for instructions on maintenance for the item(s) referenced within this section.
4. Refer to the Section 9: AAL-312-065-701 Illustrated Parts Breakdown for the part numbers of the item(s) referenced within this section.

 Remove and retain for future use.

Installation Instructions

AFT Cabin Floor Protection, Kit, AAL-312-060-001

1. Gain access to the composite panel section of the cabin floor. Temporarily remove all passenger seats. Reference Figure 1.
2. Remove and retain for future use, 100X existing screws from the three composite panel areas. Reference Figure 1, Flag note 1.
3. Install 46X Screw, Washer Head, (Item 27), in locations shown. Reference Figure 1.

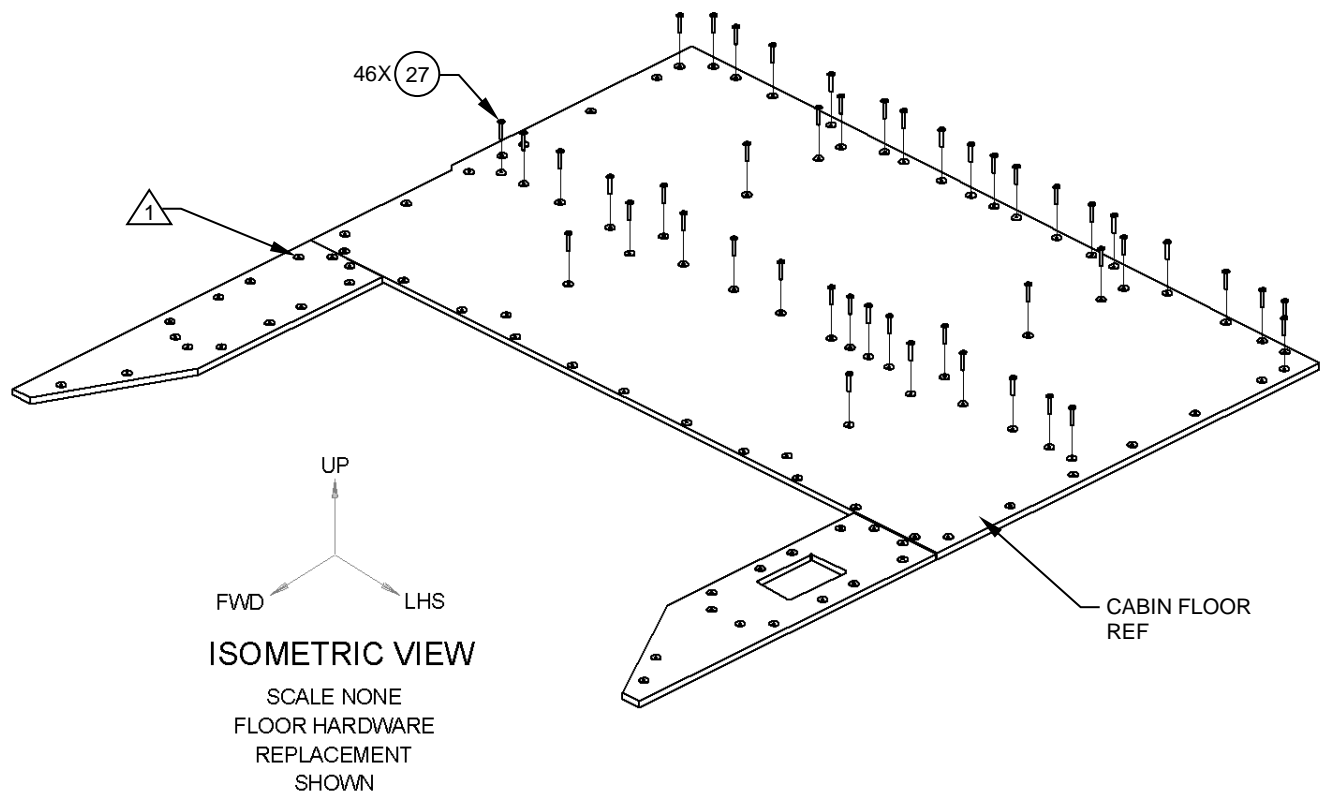

Figure 1
Some Items
Removed for
Clarity

Installation Instructions (cont.)

AFT Cabin Floor Protection, Kit, AAL-312-060-001

4. Install the AFT Cabin Floor Protection, Assy, (Item 2), and the RHS, FWD Panel, Assy, (Item 13) in their respective locations. Reference Figure 2.

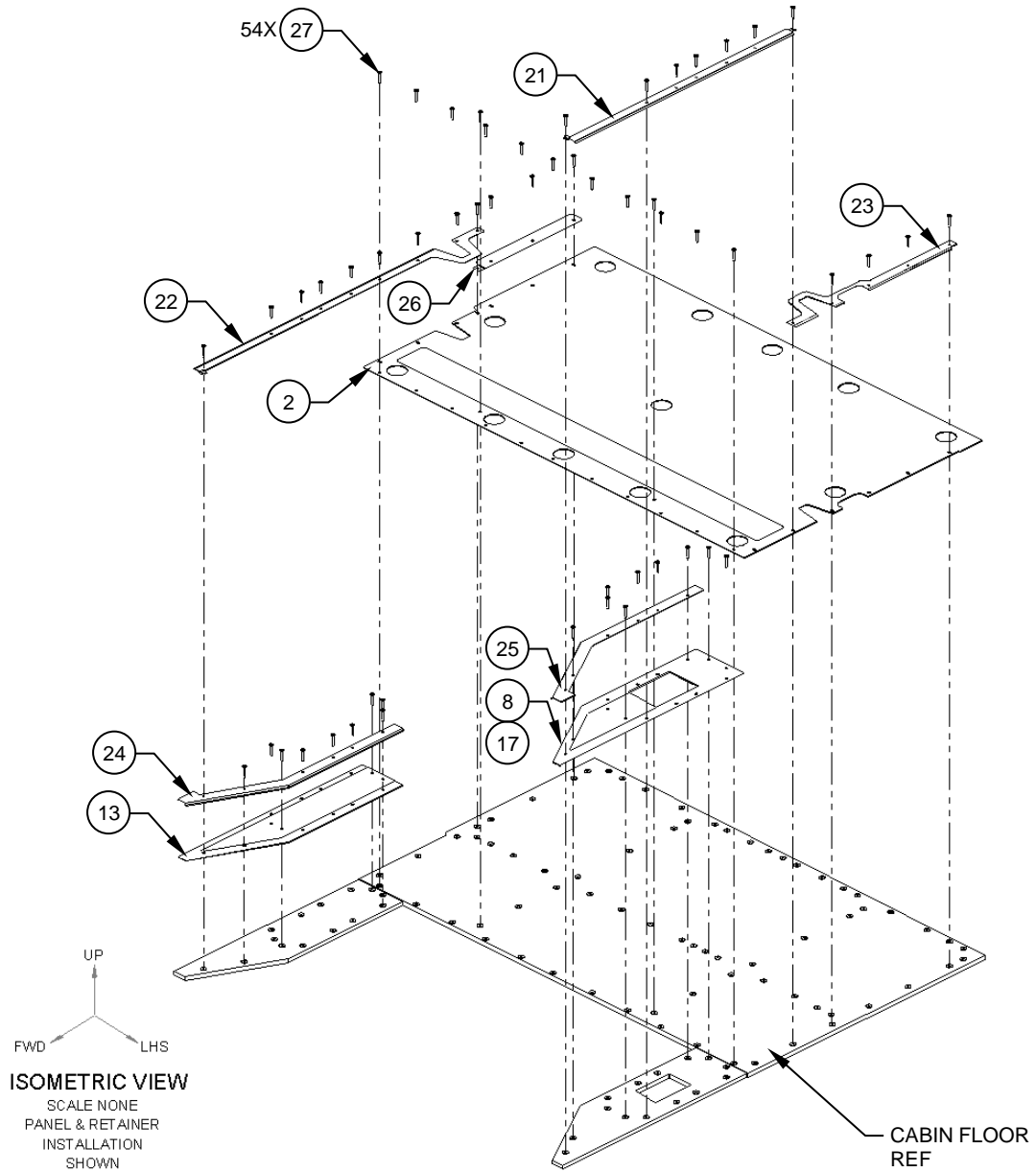

Figure 2
Some Items
Removed for
Clarity

Installation Instructions (cont.)

AFT Cabin Floor Protection, Kit, AAL-312-060-001

5. For aircraft configured for **dual controls**, install the LHS, FWD Panel, Assy, (Item 8), in its respective location. Reference Figure 2.
6. For aircraft configured for **single controls**, install the LHS, FWD Panel, Non Dual, Assy, (Item 17, in its respective location. Reference Figure 2.
7. Install the 1x LHS FWD Sill, Detail, (Item 21), 1x RHS FWD Sill, Detail, (Item 22), 1x LHS AFT Sill, Detail, (Item 23), 1x RHS INBD Sill, Detail, (Item 24), 1x LHS INBD Sill, Detail, (Item 25), and 1x RHS AFT, Sill, Detail, (Item 26), from their respective locations. Reference Figure 2.
8. Install 54x Screw, Washer Head, (Item 27), in the locations shown. Reference Figure 2.
9. Installation complete
10. Perform a General Inspection of all items to ensure proper installation.
11. Update the aircraft logbook for the installation of AFT Cabin Floor Protection, Kit.

Removal Instructions

1. Remove all components associated with the Cabin Floor Protection, Kit.
2. Replace Screw, Washer Head, (Item 27), with OEM fastener, see Step 2.
3. Perform a General Inspection of all items to ensure proper removal.
4. Update the aircraft logbook for the removal of the Cabin Floor Protection, Kit.

Installation Instructions (cont.)

FWD Floor Protection Panel, Kit, AAL-312-060-002

1. Gain access to the sheet metal floor in front of the crew seats cabin floor. Temporarily remove all crew seats. Reference Figure 3.
2. Remove and retain, the fire extinguisher, extinguisher bracket & associated fasteners. Reference Figure 3.

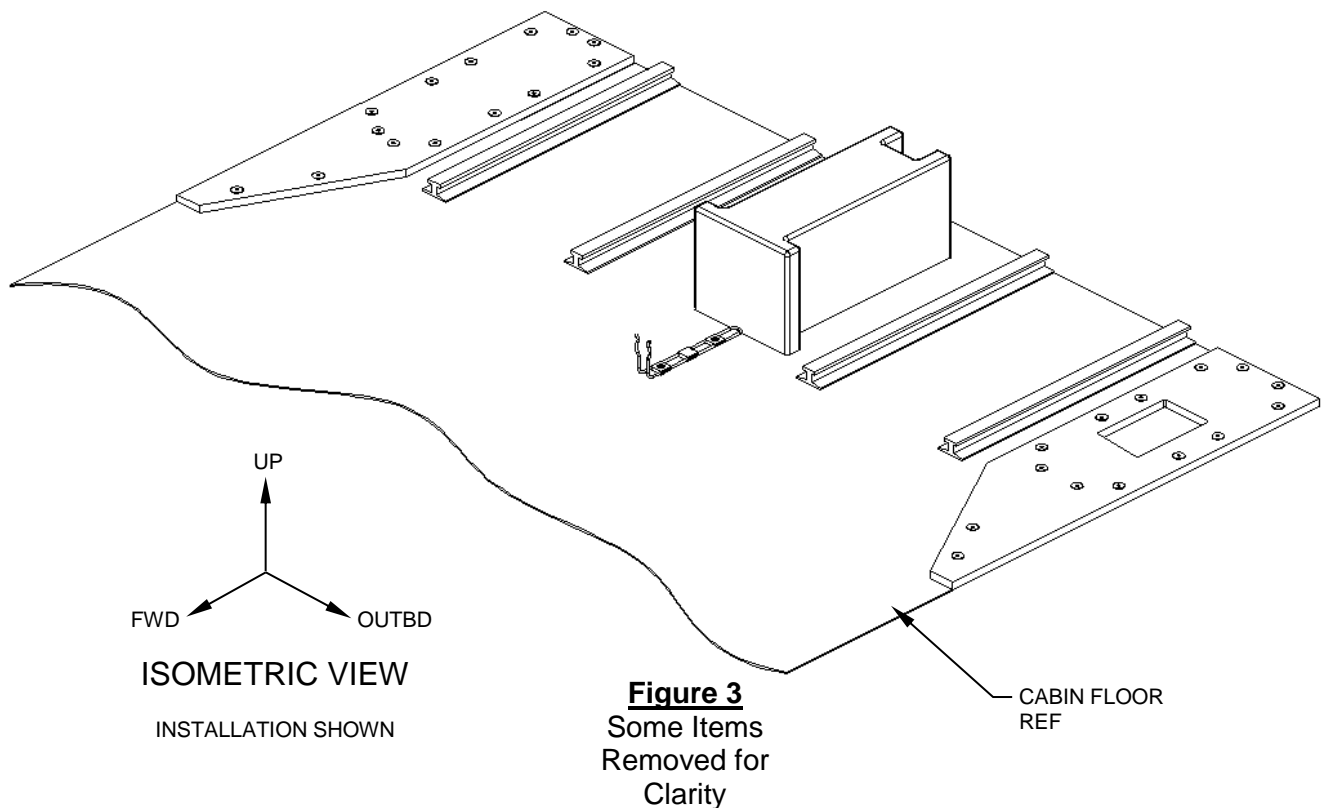

3. Temporarily install the FWD Floor Protection Panel, Assy, (Item 29) in its respective location. Reference Figure 4.
4. Transfer 8x the corner positions for the Velcro, Detail, (Item 38), using a permanent marker. Reference Figure 4.

Installation Instructions (cont.)

FWD Floor Protection Panel, Kit, AAL-312-060-002

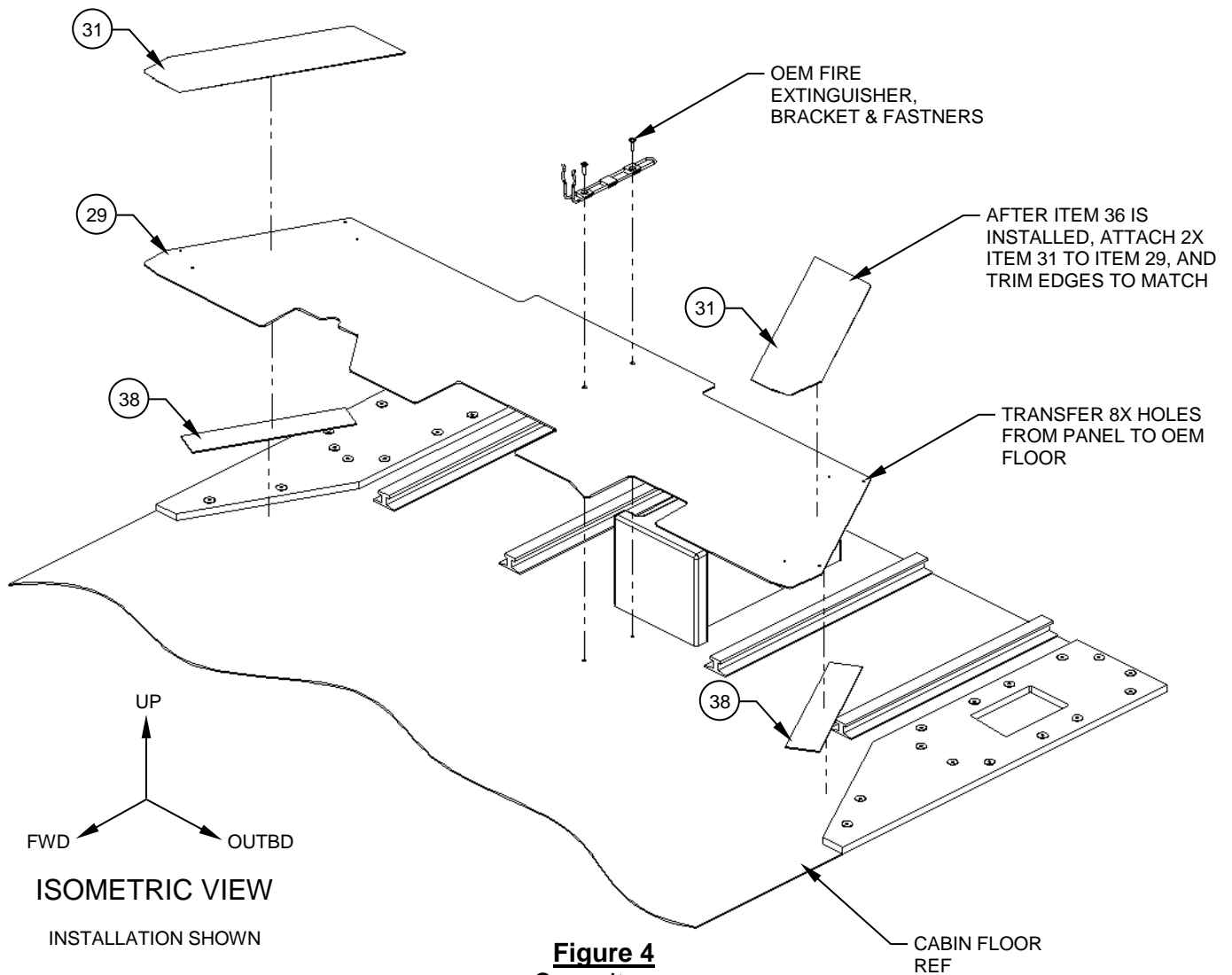

Figure 4
Some Items
Removed for
Clarity

5. Install 2x Velcro, Detail, (Item 38), using the locations marked in step 4. Reference Figure 4.
6. Install the loose 2x Grip Tap, (Item 31) along the edges of the FWD Cabin Floor Protection, Assy, (Item 29), and trim to match the remaining edges. Reference Figure 4.

Installation Instructions (cont.)

FWD Floor Protection Panel, Kit, AAL-312-060-002

7. Install the FWD Cabin Floor Protection, Assy, (Item 29), onto the 2x Velcro, Detail, (Item 38), and re-install the fire extinguisher & bracket, using the retained fasteners. Reference Figure 4.
8. Installation complete
9. Perform a General Inspection of all items to ensure proper installation.
10. Update the aircraft logbook for the installation of FWD Floor Protection Panel, Kit.

Removal Instructions

1. Remove all components associated with the FWD Floor Protection Panel, Kit.
2. Perform a General Inspection of all items to ensure proper removal.
3. Update the aircraft logbook for the removal of the Cabin Floor Protection, Kit.