

## **AFT PEDESTAL STOWAGE COMPARTMENT, KIT INSTRUCTIONS FOR CONTINUING AIRWORTHINESS**

**MODELS: BELL 205A, 205A-1, 205B, 212, 412,  
412CF, 412EP**

Read all of the Instructions for Continuing Airworthiness  
thoroughly prior to performing any activities relating to this product

## Table of Contents

<u>Section</u>	<u>Description</u>	<u>Page</u>
1	Description	2
2	Maintenance Manual Supplement	3
	Airworthiness Limitations	4
	Inspection Procedures	5
	Repair Procedures	6
3	Removal & Replacement Instructions	7
	Removal Instructions	8
	Replacement Instructions	10
4	Illustrated Parts Breakdown	11

## Notes

1. If changes to this document are required, Alpine Aerotech LP shall revise all pages and reissue the entire document.
2. Alpine Aerotech LP shall make any subsequent revisions of this document available free of charge upon request. Alpine Aerotech LP also recommends that the end user of this product periodically verify the revision level of this document.

## SECTION 1: DESCRIPTION

The following information provides a functional description of the Aft Pedestal Stowage Compartment, Assy as defined in Alpine Aerotech LP authority dataset AAL-290-070-001.

- For original/existing aircraft design which has no dedicated stowage to hold flight manuals, logbooks and any other loose contents securely.
- There's one configuration for both standard aircraft and aircraft that have been modified with AAL's Pedestal Riser. There will be a paddle-handle push-to-close latch on the lid for simple opening, additional drink holders for flight crew and a radio pocket, all within a close range convenient for the operators.

## **SECTION 2: MAINTENANCE MANUAL SUPPLEMENT**

### **General Notes**

1. The following information defines the instructions for continuing airworthiness, repair allowances and airworthiness limitations for the item(s) referenced within this document.
2. Refer to the current revisions of the Bell 205A, 205A-1, 205B, 212, 412, 412CF, 412EP Maintenance Manual for Instructions for Maintenance/Inspection with respect to the item(s) referenced within this document.
3. Refer to the Section 3: Installation & Removal Instructions and Section 4: Illustrated Parts Breakdown for the replacement and/or installation of the item(s) referenced within this section.
4. Scheduled inspection for the item(s) referenced within this document shall be accomplished in accordance with (IAW) the Inspection Procedures specified.
5. Repair allowances for the item(s) referenced within this document shall be accomplished IAW the Repair Procedures specified.
6. Limitations for the item(s) referenced within this document are IAW the Airworthiness Limitations specified.

## Airworthiness Limitations

The Airworthiness Limitations section is approved by the Minister and specifies maintenance required by any applicable airworthiness or operating rule unless an alternative program has been approved by the Minister.

The Airworthiness Limitations section is FAA approved and specifies maintenance required under Sections 43.16 and 91.403 of the Federal Aviation Regulations unless an alternative program has been FAA approved.

## **Supplement to applicable Maintenance Manual, Chapter 4, Airworthiness Limitations Schedule**

### Notes

1. Refer to the applicable Maintenance Manual, Chapter 4-1, for general information on airworthiness limitations and airworthiness limitation schedules.
2. Item(s) **not** listed in the Scheduled Airworthiness Limitations section within this document have an unlimited airworthiness life.

### Scheduled Airworthiness Limitations

1. There are no airworthiness limitations associated with the item(s) referenced within this document.

## Inspection Procedures

### **Supplement to applicable Maintenance Manual, Chapter 5, Inspection and Component Overhaul Schedule**

#### Notes

1. Refer to the applicable Maintenance Manual, Chapters 5-1, for general information on inspections, inspection definitions, inspection intervals, inspection methods and inspection schedules.
2. Detailed Inspections, as indicated within this document, are defined as visual and thorough, searching checks.
3. Perform 300 Hour/12 Month Inspections every 300 hours or every 12 months, whichever occurs first, prior to flight operation. If damage is detected, refer to the Repair Procedures section within this document.

#### Scheduled Inspections

1. 300 Hour/12 Month Inspections

Data Reference: Section 3: Installation and Removal Instructions  
Section 4: Illustrated Parts Breakdown

- I. Perform a Detailed Inspection on all items to ensure proper security.
- II. Perform a Detailed Inspection on all items/materials to ensure proper integrity.
- III. Perform a Detailed Inspection on the Aft Pedestal Stowage Compartment, Assy to ensure that no parts have come loose.
- IV. Perform a Detailed Inspection on all surfaces to ensure no damage has occurred to the Aft Pedestal Stowage Compartment, Assy.

## Repair Procedures

1. Repairs to the item(s) referenced within this document are **not** permitted. Contact Alpine Aerotech LP for further information if repairs are required to the item(s) referenced within this document.

## **SECTION 3: REMOVAL & REPLACEMENT INSTRUCTIONS**

### **Weight & Balance**

<u>Part Number</u>	<u>Description</u>	<u>Weight</u>	<u>Long. Arm</u>	<u>Lat. Arm</u>
AAL-290-070-001	Aft Pedestal Stowage Compartment, Kit	6.37*	63.13	0.94RBL
		2.89 (Kg)	1.60 (m)	.024 (m)

\* Total increase in weight to aircraft.

### **General Notes**

1. All Installation Instructions shall be accomplished in accordance with (IAW) standard aircraft practices. Refer to the current revision of the FAA manuals AC 43.13-1B and AC 43.13-2B for details on standard aircraft practices.
2. All Dimensions are in imperial measures (inches/pounds).
3. Refer to Section 2: Maintenance Manual Supplement for instructions on maintenance for the item(s) referenced within this section.
4. Refer to Section 4: Illustrated Parts Breakdown for the part numbers of the item(s) referenced within this section.

### **Installation Notes**

 Typical item number for all like items in this view unless otherwise specified.

**Removal Instructions**

1. Gain access to the OEM center pedestal located on the floor of the aircraft. Reference Figure 1.
2. Remove 4x screws (Item 22), and 4x washers (Item 21) to remove the Pedestal Attachment Flange (Item 19) from the OEM center pedestal. The flange is permanently attached to the Pedestal Stowage Compartment, therefore has no removal instructions.

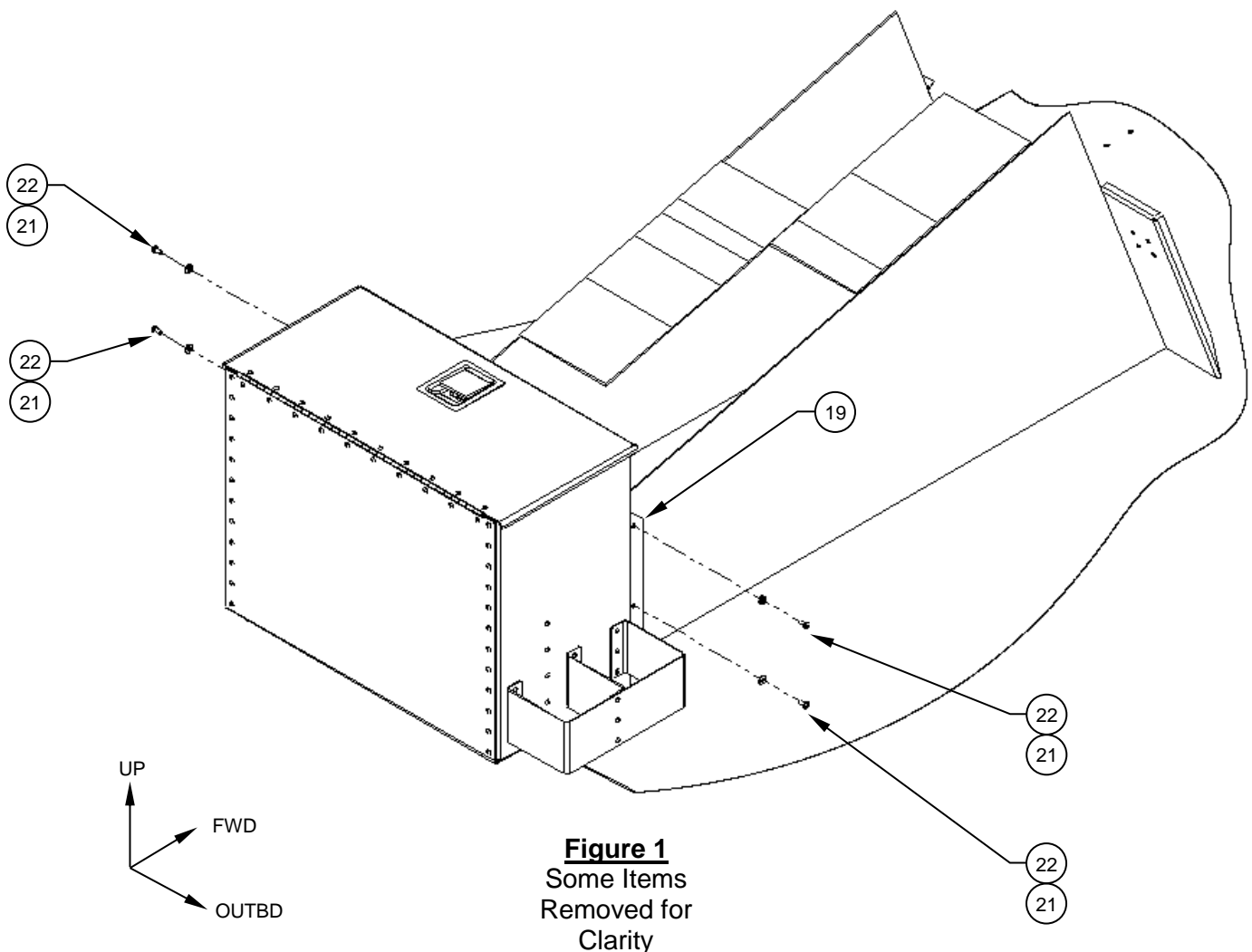



**Removal Instructions (Cont.)**

3. Removal complete.
4. Perform a General Inspection of all items to ensure proper removal.
5. Update the aircraft logbook for the removal of the Aft Pedestal Stowage Compartment, Assy.

### **Replacement Instructions**

1. As there are no special considerations or additional steps to replace the Aft Pedestal Stowage Compartment, Kit for either inspections, or mission configuration, the replacement of the Aft Pedestal Stowage Compartment, Kit can be considered the opposite of removal.
2. Perform General Inspection of all items to ensure proper installation.
3. Update the aircraft logbook for the installation of the Aft Pedestal Stowage Compartment, Kit.

**SECTION 4: ILLUSTRATED PARTS BREAKDOWN**

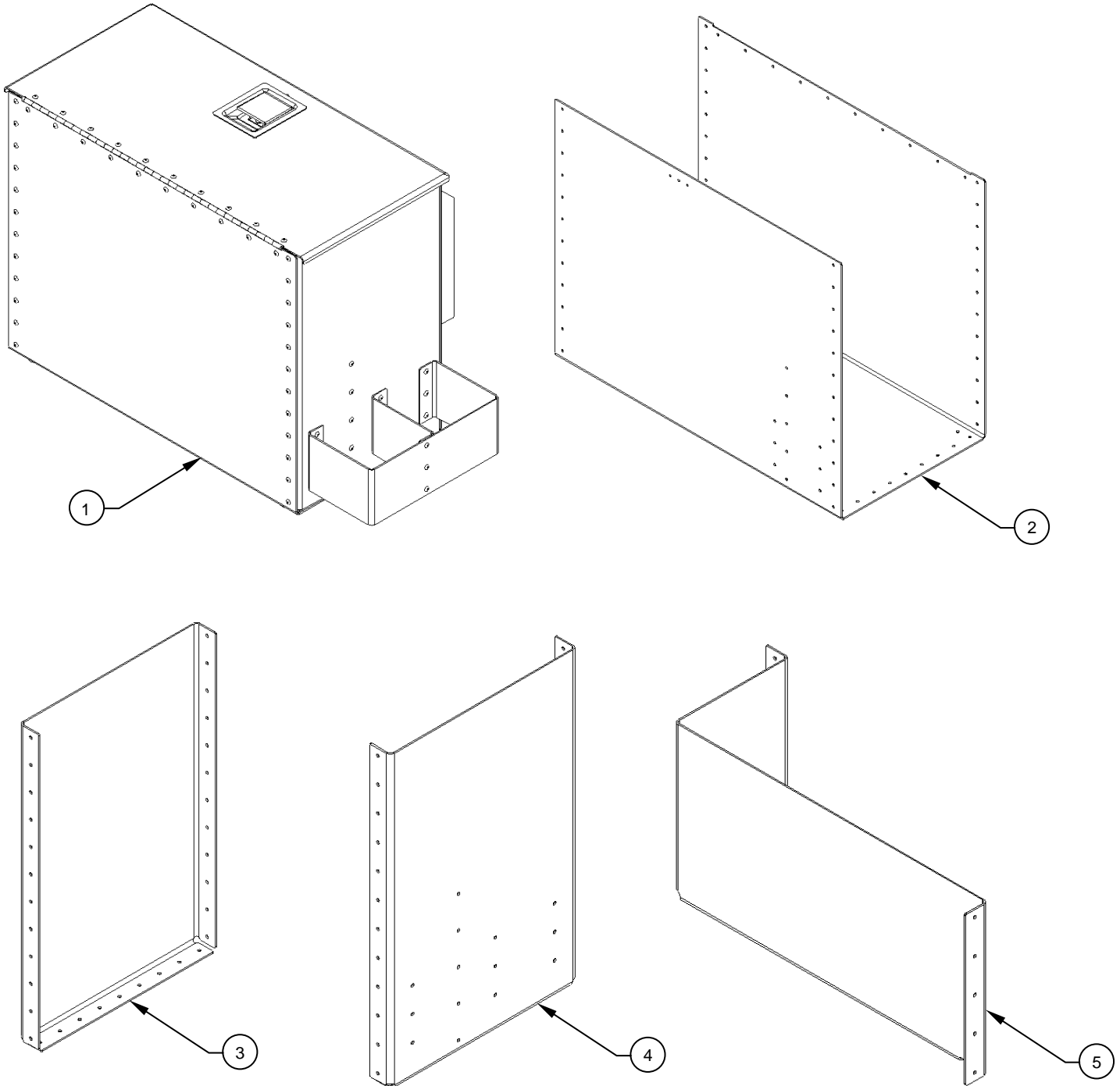

**Illustrated Parts Breakdown (Cont.)**

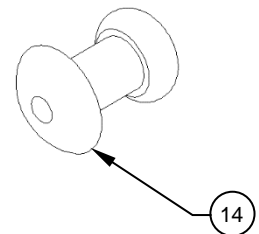
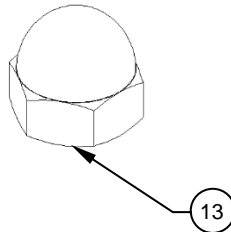
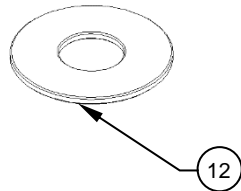
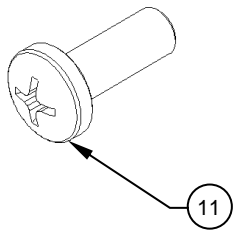
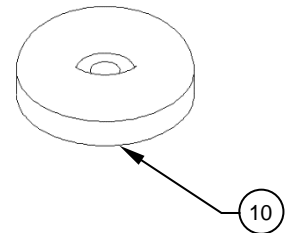
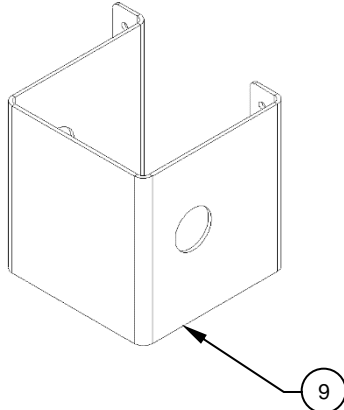
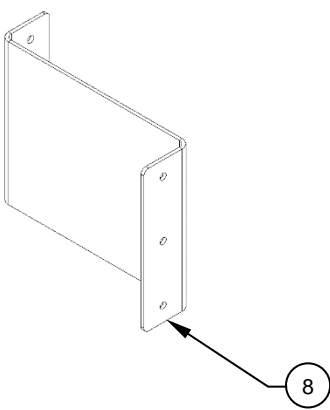
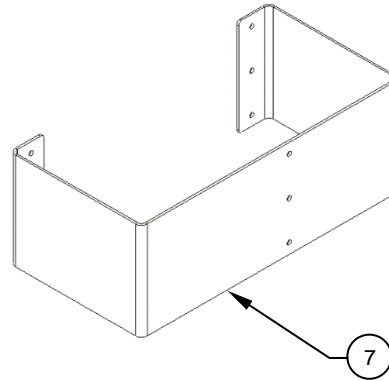
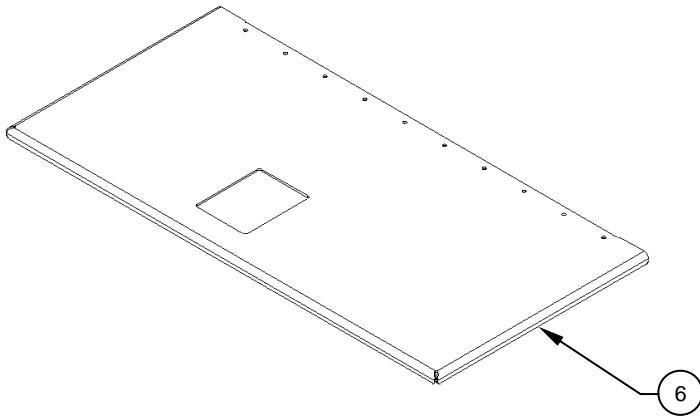

**Illustrated Parts Breakdown (Cont.)**

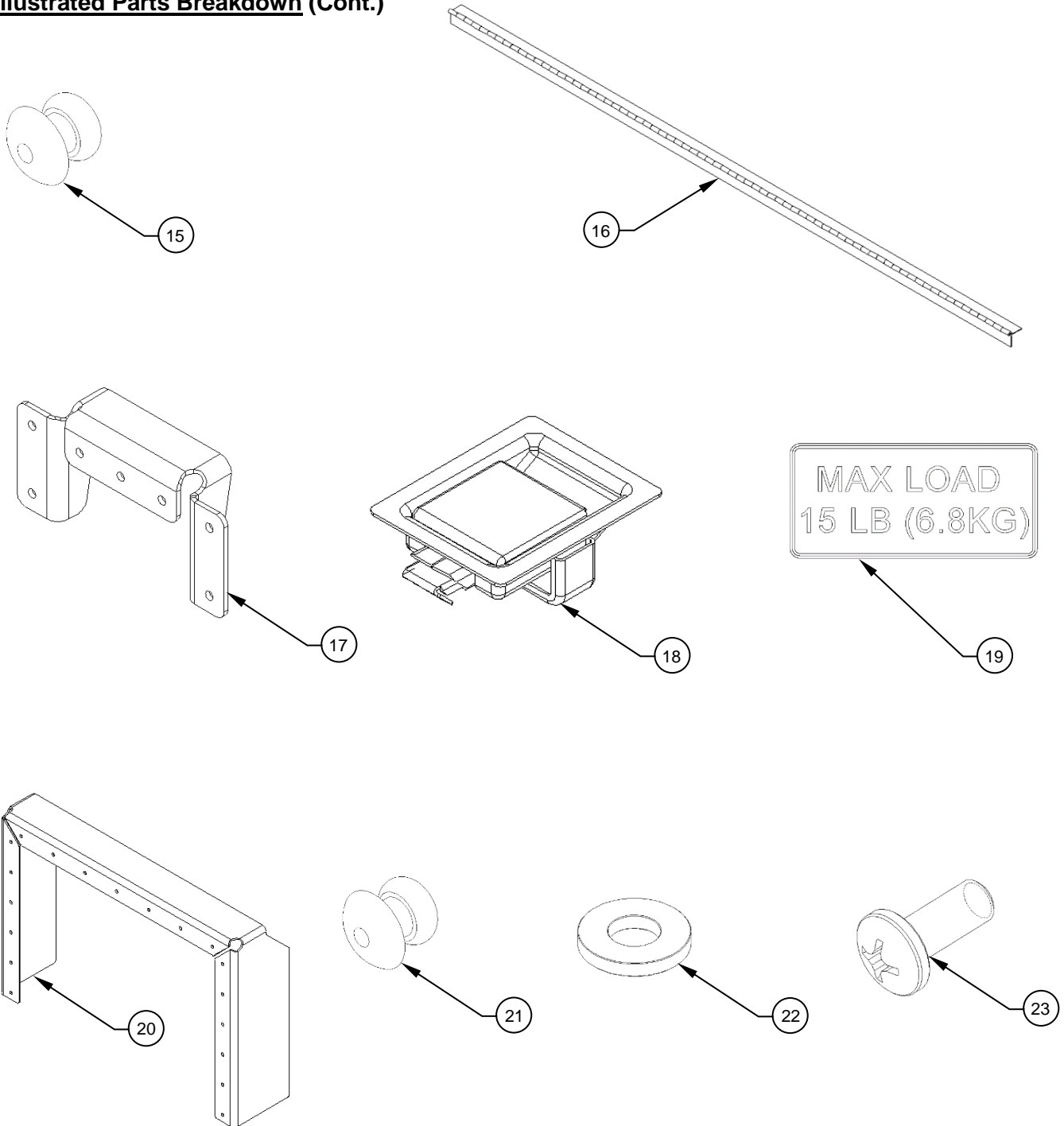

## Illustrated Parts Breakdown (Cont.)

ITEM	QTY	NUMBER	DESCRIPTION	MATERIAL	REF STOCK SIZE	SPEC	FINISH	MANUFACTURER	NCAGEC
-	-	AAL-290-070-001	AFT PEDESTAL STOWAGE COMPARTMENT, KIT	NA	NA	NA	NA	ALPINE AEROTECH LP	L0171
1	1	AAL-290-071-001	AFT PEDESTAL STOWAGE COMPARTMENT, ASSY	NA	NA	NA	NA	ALPINE AEROTECH LP	L0171
2	1	>AAL-290-072-001	BODY, DETAIL	6061-T6 ALUMINUM	.063"	AMS 4027	SEE SPEC	ALPINE AEROTECH LP	L0171
3	1	>AAL-290-072-002	WALL LHS, DETAIL	6061-T6 ALUMINUM	.063"	AMS 4027	SEE SPEC	ALPINE AEROTECH LP	L0171
4	1	>AAL-290-072-003	WALL RHS, DETAIL	6061-T6 ALUMINUM	.063"	AMS 4027	SEE SPEC	ALPINE AEROTECH LP	L0171
5	1	>AAL-290-072-004	INNER DIVIDER FLANGE, DETAIL	6061-T6 ALUMINUM	.063"	AMS 4027	SEE SPEC	ALPINE AEROTECH LP	L0171
6	1	>AAL-290-072-005	LID, DETAIL	6061-T6 ALUMINUM	.063"	AMS 4027	SEE SPEC	ALPINE AEROTECH LP	L0171
7	1	>AAL-290-072-006	DRINK HOLDER FLANGE, DETAIL	6061-T6 ALUMINUM	.063"	AMS 4027	SEE SPEC	ALPINE AEROTECH LP	L0171
8	1	>AAL-290-072-007	DRINK DIVIDER FLANGE, DETAIL	6061-T6 ALUMINUM	.063"	AMS 4027	SEE SPEC	ALPINE AEROTECH LP	L0171
9	1	>AAL-290-072-008	RADIO POCKET FLANGE, DETAIL	6061-T6 ALUMINUM	.063"	AMS 4027	SEE SPEC	ALPINE AEROTECH LP	L0171
10	4	>9540K77	UNTHREADED BUMPER	SBR RUBBER	NA	NA	NA	MCMaster CARR	NA
11	4	>MS35206-214	SCREW, MACHINE, PAN-HEAD	SEE SPEC	SEE SPEC	NASM35206	SEE SPEC	SOURCE AS REQUIRED	NA
12	4	>NAS1149CN416R	WASHER, FLAT	SEE SPEC	SEE SPEC	NAS1149	SEE SPEC	SOURCE AS REQUIRED	NA
13	4	>90507A209	DISTORTED-THREAD CAP LOCKNUT	18-8 STAINLESS STEEL	NA	NA	NA	MCMaster CARR	NA
14	7	>MS20470AD3-4	RIVET, SOLID, UNIVERSAL HEAD	SEE SPEC	SEE SPEC	NASM20470	SEE SPEC	SOURCE AS REQUIRED	NA
15	128	>MS20470AD4-4-5	RIVET, SOLID, UNIVERSAL HEAD	SEE SPEC	SEE SPEC	NASM20470	SEE SPEC	SOURCE AS REQUIRED	NA
16	1	>MS20001-4-XX	PIANO HINGE WITHOUT HOLES	NA	NA	NA	NA	SOURCE AS REQUIRED	L0171
17	1	>AAL-290-072-010	STRIKER PLATE, DETAIL	301-1/2 HARD STAINLESS STEEL	.050"	AMS 5518	SEE SPEC	ALPINE AEROTECH LP	L0171
18	1	>64-21-11	PADDLE-HANDLE PUSH-TO-CLOSE LATCH	STEEL	NA	NA	NA	SOUTHCO	NA
19	1	AAL-290-072-011	DECAL, DETAIL	VINYL 3650-10	.002"	3M	SEE SPEC	SCOTCHCAL	OYMX0
20	1	AAL-290-072-009	PEDESTAL ATTACHMENT FLANGE, DETAIL	6061-T6 ALUMINUM	.063"	AMS 4027	SEE SPEC	ALPINE AEROTECH LP	L0171
21	19	MS20470AD4-4-5	RIVET, SOLID, UNIVERSAL HEAD	SEE SPEC	SEE SPEC	NASM20470	SEE SPEC	SOURCE AS REQUIRED	NA
22	4	NAS1149C0363R	WASHER, FLAT	SEE SPEC	SEE SPEC	NAS1149	SEE SPEC	SOURCE AS REQUIRED	NA
23	4	MS27039-0806	SCREW, MACHINE	SEE SPEC	SEE SPEC	NASM27029	SEE SPEC	SOURCE AS REQUIRED	NA