

CENTER PEDESTAL RISER, KIT INSTRUCTIONS FOR CONTINUING AIRWORTHINESS

**MODELS: BELL 205A, 205A-1, 205B, 212, 412, 412EP
&412CF**

Read all of the Instructions for Continuing Airworthiness
thoroughly prior to performing any activities relating to this product

Table of Contents

Section 1	Introduction	2
Section 2	Description	3
Section 3	Maintenance Instructions.....	4
Section 4	Removal/Replacement	7
Section 6	Airworthiness Limitations	8
Section 7	Illustrated Parts Breakdown.....	9
	BOM Illustrated Parts Breakdown (cont.).....	17

Notes

1. If changes to this document are required, Alpine Aerotech LP shall revise all pages and reissue the entire document.
2. Alpine Aerotech LP shall make any subsequent revisions of this document available free of charge upon request. Alpine Aerotech LP also recommends that the end user of this product periodically verify the revision level of this document.

Section 1 Introduction

This document comprises Instructions for Continuing Airworthiness that apply to the AAL Center Pedestal Riser, Kit installed on Bell 205, 212 & 412 rotorcraft. The information and data contained in this document are supplemental to the information contained in the existing ICA for the Bell 205, 212 & 412.

Applicability

The Center Pedestal Riser, Kit (AAL-280-090-001) is applicable to all serial numbers of the Bell 205A, 205A-1, 205B, 212, 412, 412EP & 412CF Medium Helicopters.

Section 2 Description

The following information provides a functional description of the Center Pedestal Riser, Kit as defined in Alpine Aerotech LP authority dataset AAL-280-090-001.

- Due to the changing requirements of operator missions there is a requirement to have an ability to mix rack mounted and panel mounted avionics in the center pedestal of Bell medium aircraft.
- When installed, the Center Pedestal Riser, Kit provides maximum flexibility to configure the center pedestal with a mixture of rack and panel mounted devices. The increase in height at the AFT end of the pedestal allows for longer instruments to be mounted if required. The change in angle reduces glare from ambient light sources and therefore increases readability for the pilot/copilot allowing the flight crew to more easily read the displays.

Section 3 Maintenance Instructions

General Notes

1. The following information defines the instructions for continuing airworthiness, repair allowances and airworthiness limitations for the item(s) referenced within this document.
2. Refer to the current revision of the BHT 205A, 205A-1, 205B, 212, 412, 412EP & 412CF Maintenance Manual for the chapter(s) and section(s) referenced within this document.
3. Refer to the Section 4: Removal/Replacement Instructions and Section 7: Illustrated Parts Breakdown for the replacement and/or installation of the item(s) referenced within this section.
4. Scheduled inspection for the item(s) referenced within this document shall be accomplished in accordance with (IAW) the Inspection Procedures specified.
5. Repair allowances for the item(s) referenced within this document shall be accomplished IAW the Repair Procedures specified.
6. Limitations for the item(s) referenced within this document are IAW the Airworthiness Limitations specified.
7. All Installation Instructions shall be accomplished IAW standard aircraft practices. Refer to the current revision of the FAA Advisory Circular AC 43.13-1 and AC 43.13-2 for details on standard aircraft practices.
8. Torque fasteners IAW the tension type torque limits indicated in the current revision of the FAA Advisory Circular AC 43.13-1, Table 7-1 unless otherwise specified.
9. All Dimensions are in imperial measures (inches/pounds).

Inspection Procedures

Supplement to applicable BHT 205, 212 & 412 Maintenance Manual, Chapter 04, Scheduled/Unscheduled Maintenance

Notes

1. Refer to the applicable BHT 205, 212 & 412 Maintenance Manual, Chapter 05 - Inspections as applicable, for general information on inspections, inspection definitions, inspection intervals, inspection methods and inspection schedules.
2. General Inspections, as indicated within this document, are defined as visual, non-thorough checks.
3. Detailed Inspections, as indicated within this document, are defined as visual and thorough, searching checks.
4. Perform 600 Hour/12 Month Inspections every 600 hours or every 12 months, whichever occurs first, prior to flight operation. If damage is detected, refer to the Repair Procedures section within this document.

Scheduled Inspections

1. 600 Hour/12 Month Inspections/Lightning Strike/Hard Landing

Data Reference: Section 4: Installation and Removal Instructions
Section 7: Illustrated Parts Breakdown

- i. Perform a Detailed Inspection on all items, materials and finishes in the Center Pedestal Riser, Kit for evidence of corrosion, cracks and damage.
- ii. Perform a Detailed Inspection on all items in the Center Pedestal Riser, Kit for evidence of excessive wear.
- iii. Perform a Detailed Inspection on all items, materials and finishes in the Center Pedestal Riser, Kit for proper integrity and condition.
- iv. Perform a Detailed Inspection on all hardware and fasteners in the Center Pedestal Riser, Kit for proper security and torque.

Repair Procedures

1. Repairs to the item(s) referenced within this document are **not** permitted. Contact Alpine Aerotech LP for further information if repairs are required to the item(s) referenced within this document.

Section 4 Removal/Replacement

General Notes

1. All Removal/Replacement instructions shall be accomplished in accordance with (IAW) standard aircraft practices. Refer to the current revision of the FAA Advisory Circular AC 43.13-1 and AC 43.13-2 for details on standard aircraft practices.
2. Torque fasteners IAW the tension type torque limits indicated in the most current revision of BHT-ALL-SPM, Chapter 2 unless otherwise specified.
3. All dimensions are in imperial measures (inches/pounds).
4. Refer to Section 3: Maintenance Instructions for instructions on maintenance for the item(s) referenced within this section.
5. Refer to Section 7: Illustrated Parts Breakdown for the part numbers of the item(s) referenced within this section.

Removal Instructions

1. As the installation of the Center Pedestal Riser, Kit is considered permanent, there are no special procedures for removal of the kit for maintenance activities. Should the center pedestal have a requirement to be removed for any OEM inspections, remove the entire assembly IAW the OEM removal instructions.

Section 6 Airworthiness Limitations

The Airworthiness Limitations section is approved by the Minister and specifies maintenance required by any applicable airworthiness or operating rule unless an alternative program has been approved by the Minister.

The Airworthiness Limitations section is FAA approved and specifies maintenance required under Sections 43.16 and 91.403 of the Federal Aviation Regulations unless an alternative program has been FAA approved.

Supplement to applicable BHT 205, 212 & 412 Maintenance Manual, Chapter 05, Airworthiness Limitations

Notes

1. Refer to the applicable BHT 205, 212 & 412 Maintenance Manual, Chapters 04 – Airworthiness Limitations Schedule, and 05 - Inspections, for general information on airworthiness limitations and airworthiness limitation schedules.
2. Item(s) **not** listed in the Scheduled Airworthiness Limitations section within this document have an unlimited airworthiness life.

Scheduled Airworthiness Limitations

1. There are no airworthiness limitations associated with the item(s) referenced within this document.

Section 7 Illustrated Parts Breakdown

General Notes

1. Alternate items listed where applicable.

Illustrated Parts Breakdown (cont.)

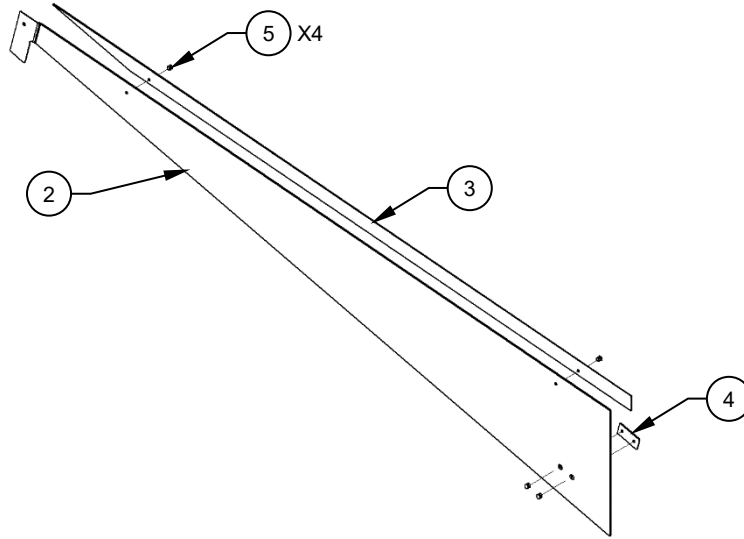

LHS Angle, Assy (Item 1)
Shown

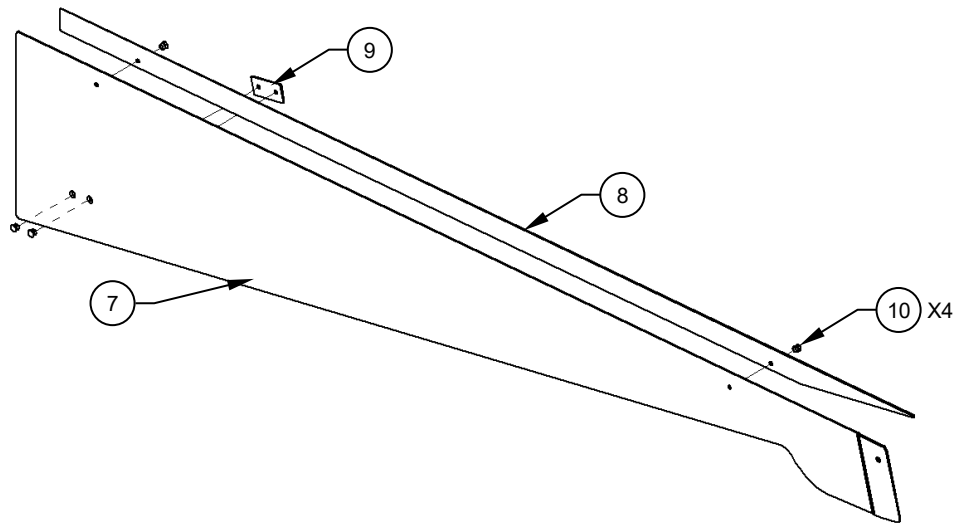

RHS Angle, Assy (Item 6)
Shown

Illustrated Parts Breakdown (cont.)

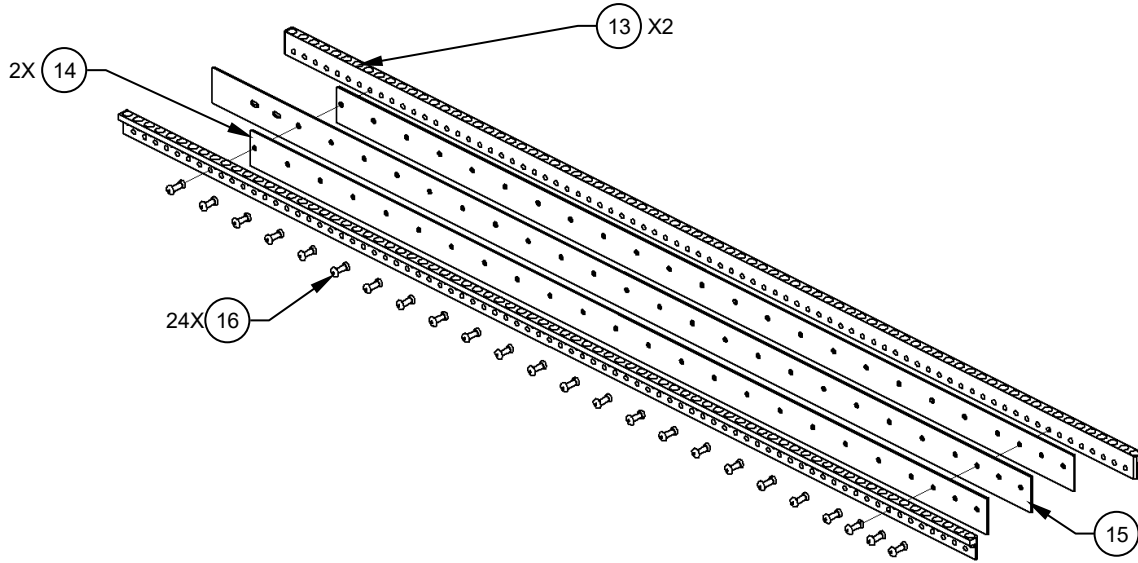

Center Dzus Rail, Assy (Item 12)
Shown

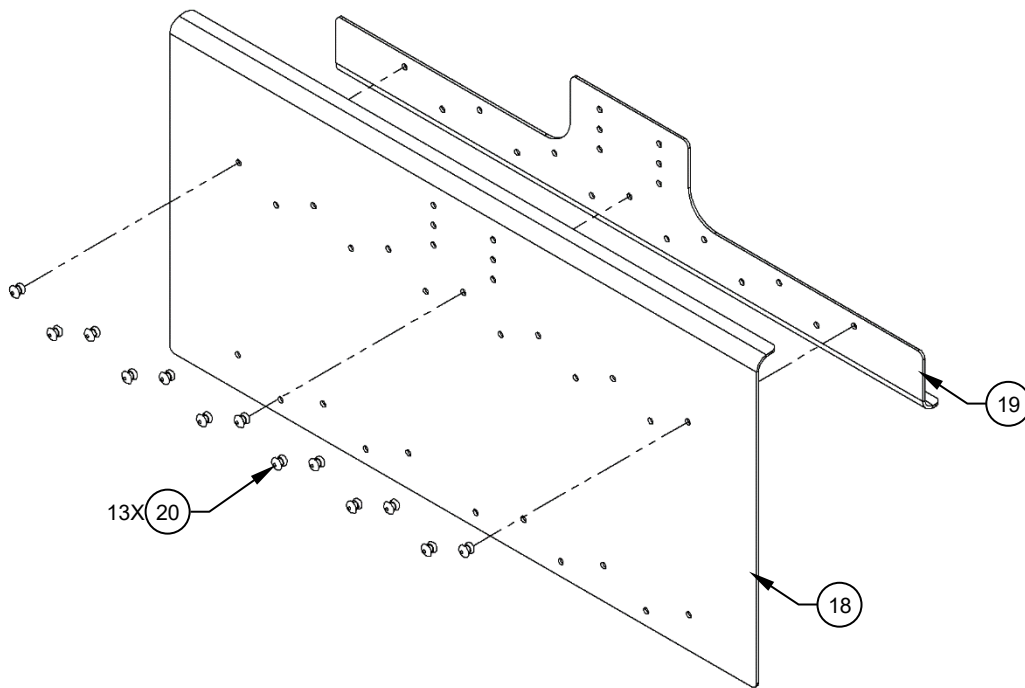

AFT Angle, Assy (Item 17)
Shown

Illustrated Parts Breakdown (cont.)

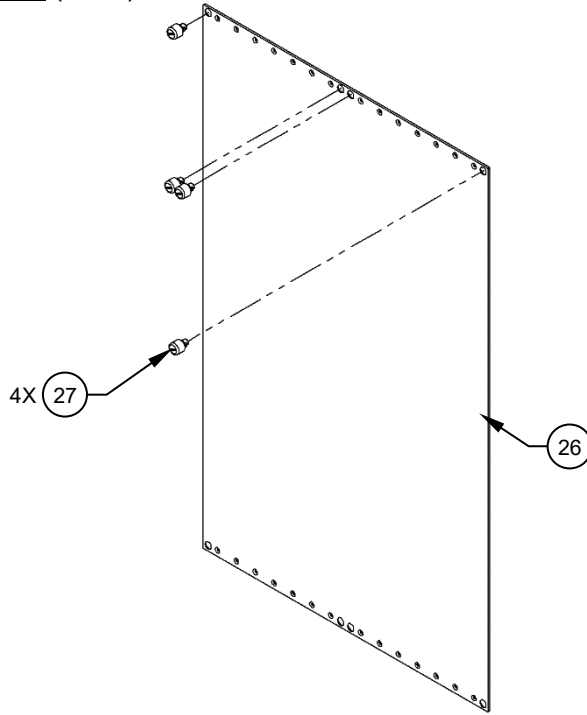

Panel Mount Plate, Assy (Item 25)
Shown

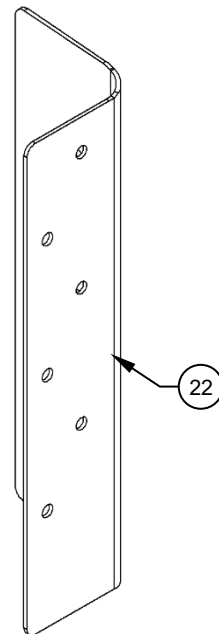
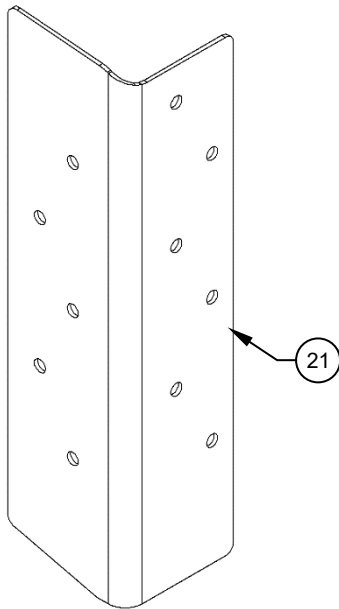

Illustrated Parts Breakdown (cont.)

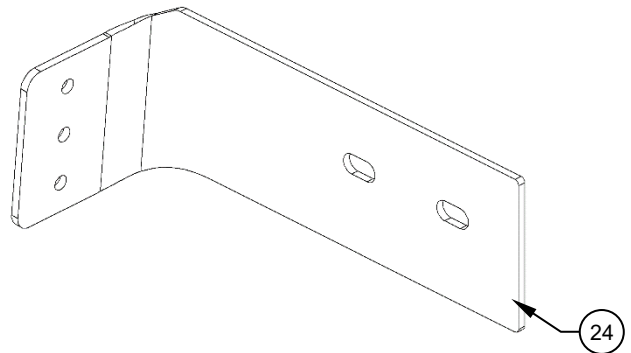
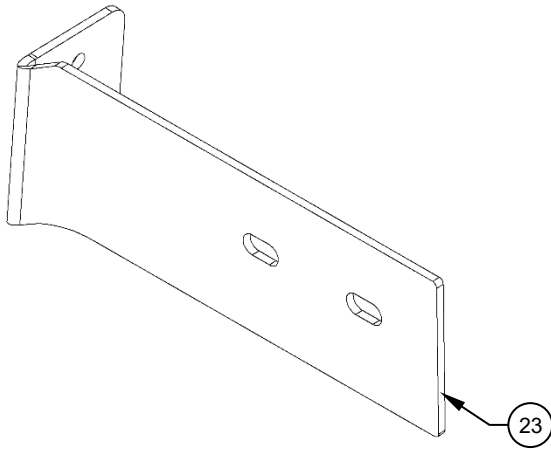
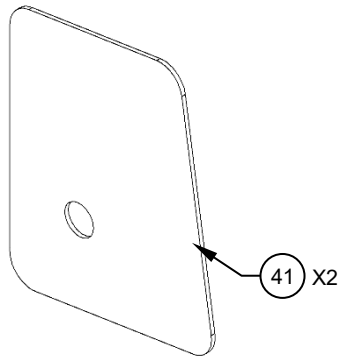

Illustrated Parts Breakdown (cont.)

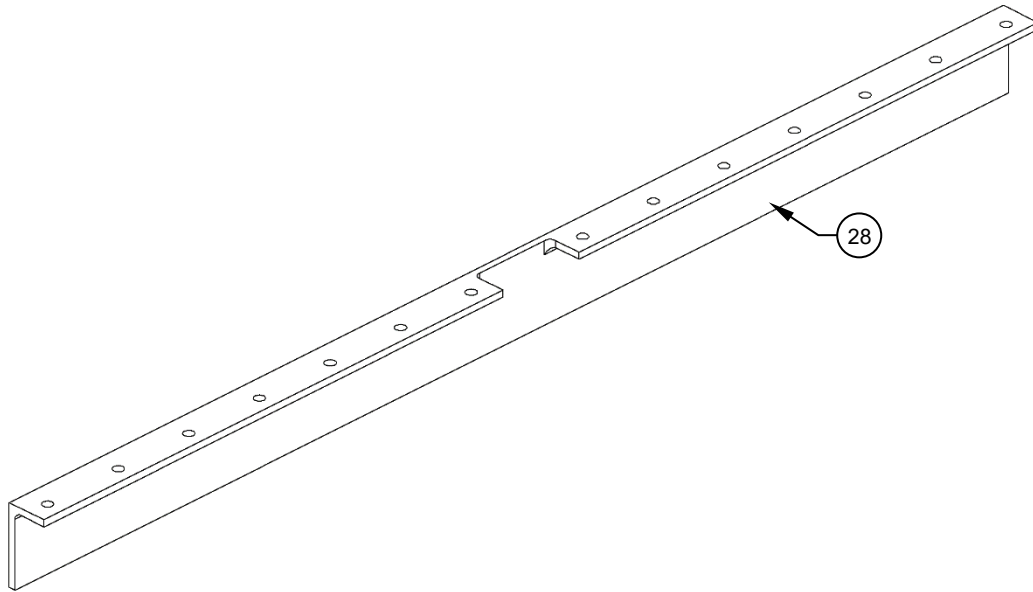

Illustrated Parts Breakdown (cont.)

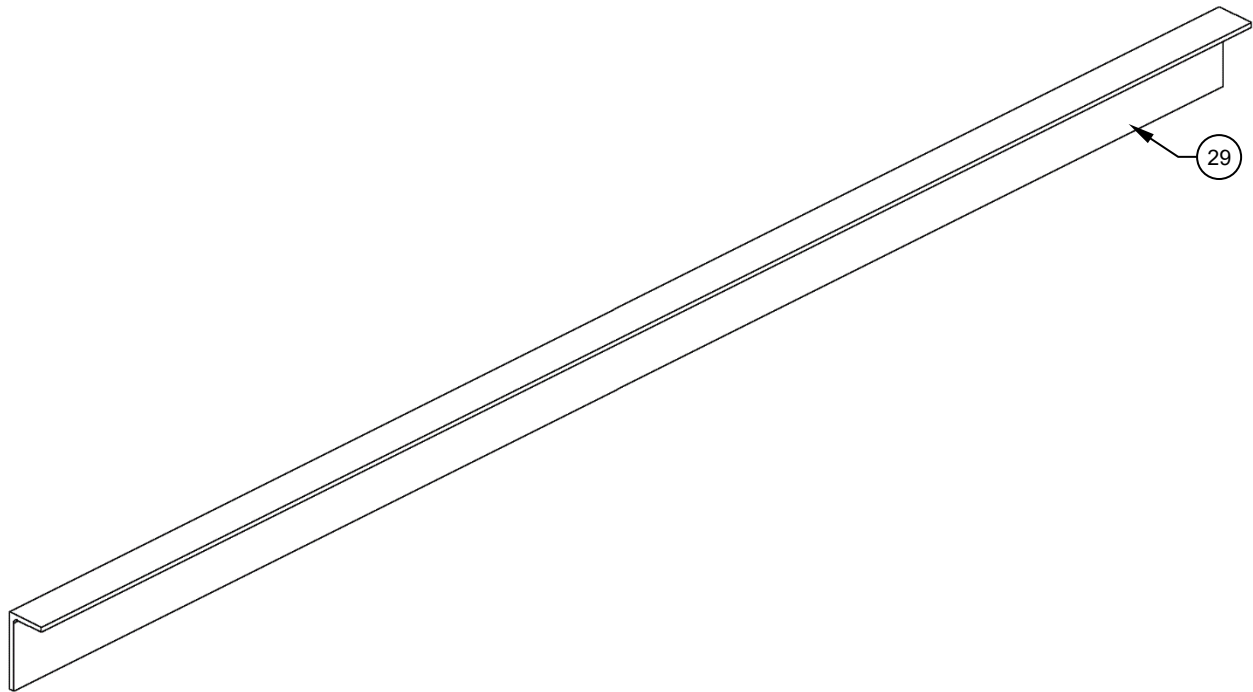
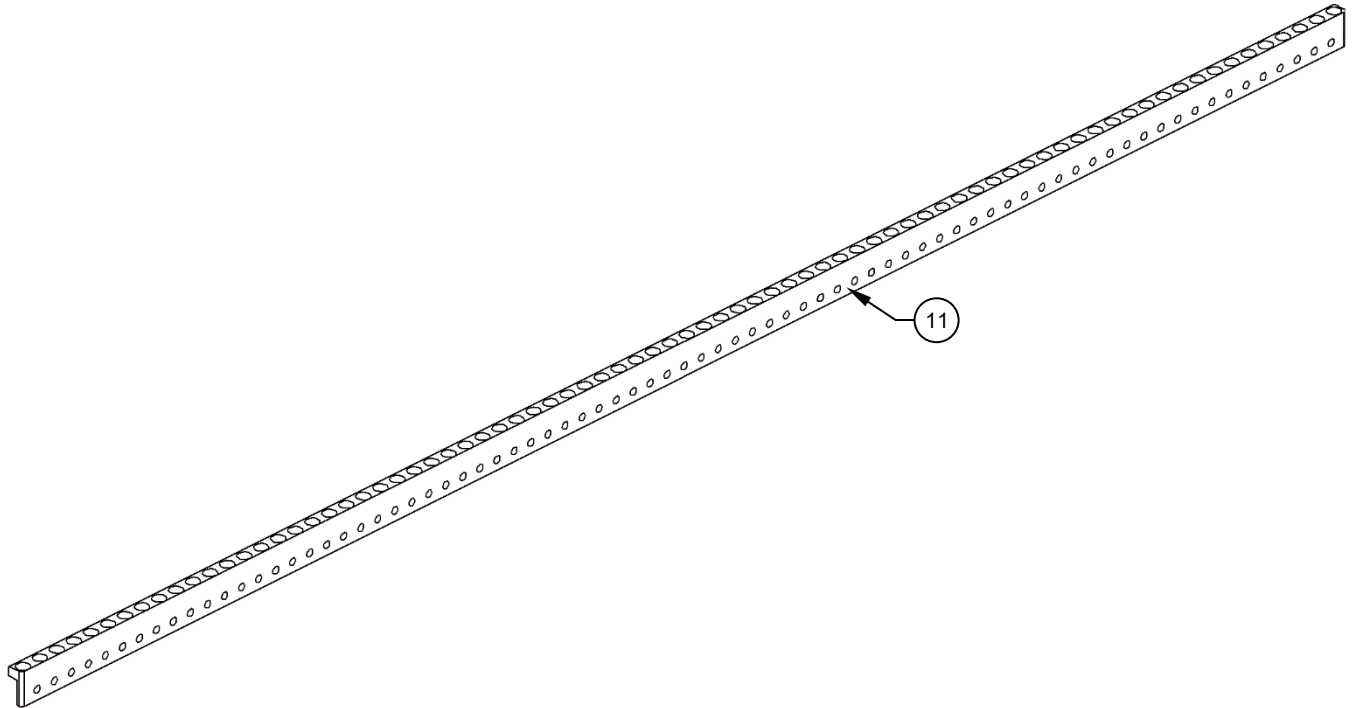

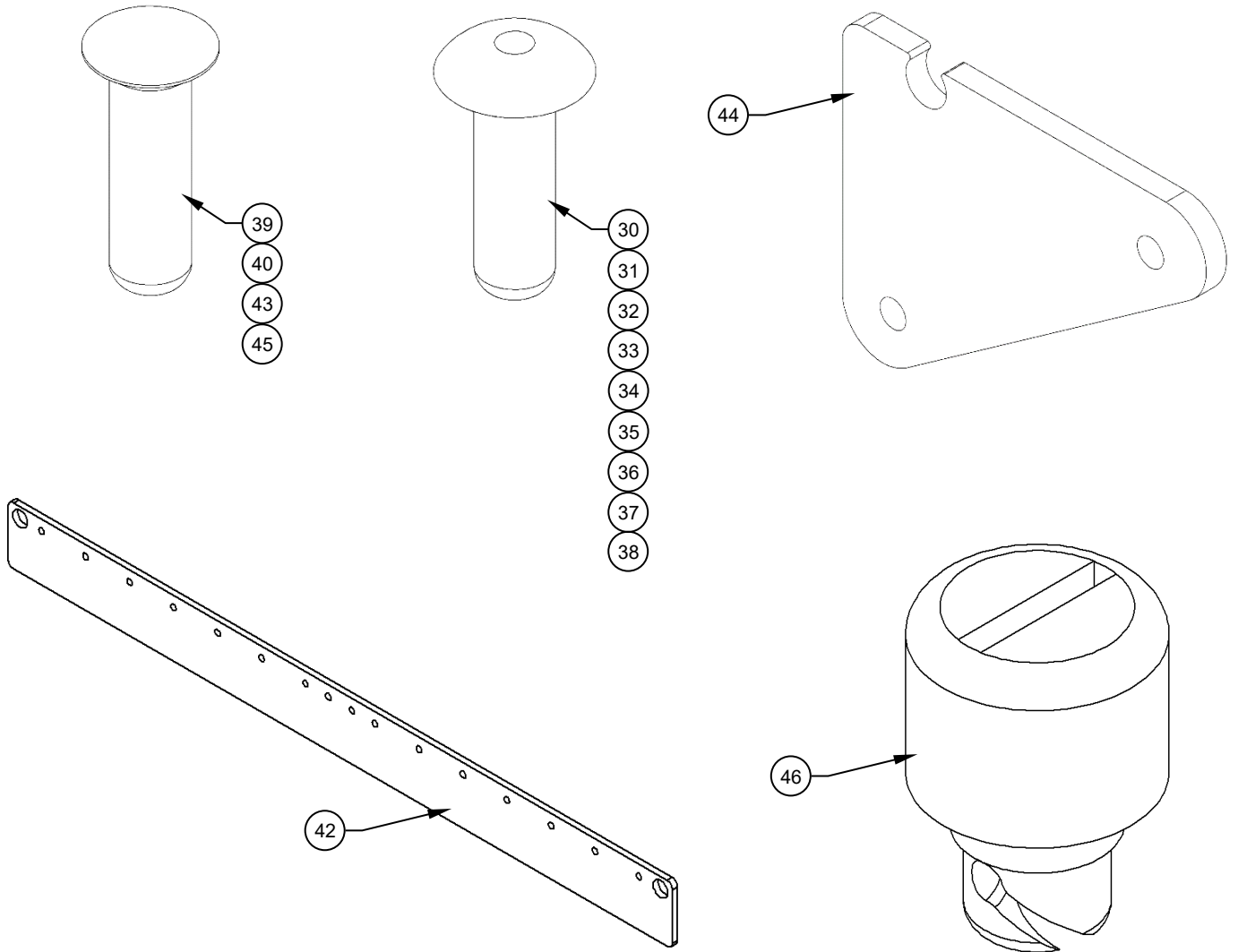

BOM Illustrated Parts Breakdown (cont.)

ITEM	QTY	NUMBER	DESCRIPTION	MATERIAL	REF STOCK SIZE	SPEC	FINISH	MANUFACTURER	NCAGEC
-		AAL-280-090-001	CENTER PEDESTAL RISER, KIT	NA	NA	NA	NA	ALPINE AEROTECH LP	L0171
1	1	AAL-280-091-001	LHS ANGLE, ASSY	NA	NA	NA	NA	ALPINE AEROTECH LP	L0171
2	1	>AAL-280-092-001	LHS FLANGE, DETAIL	NA	NA	NA	NA	ALPINE AEROTECH.LP	L0171
3	1	>AAL-280-092-003	DOUBLER, DETAIL	NA	NA	NA	NA	ALPINE AEROTECH.LP	L0171
4	1	>AAL-280-092-004	DOUBLER, DETAIL	NA	NA	NA	NA	ALPINE AEROTECH.LP	L0171
5	4	>MS20426AD3-3	RIVET, SOLID, COUNTERSUNK HEAD	SEE SPEC	SEE SPEC	NASM20426	SEE SPEC	SOURCE AS REQUIRED	NA
6	1	AAL-280-091-002	RHS ANGLE, ASSY	NA	NA	NA	NA	ALPINE AEROTECH LP	L0171
7	1	>AAL-280-092-002	RHS FLANGE, DETAIL	NA	NA	NA	NA	ALPINE AEROTECH.LP	L0171
8	1	>AAL-280-092-003	DOUBLER, DETAIL	NA	NA	NA	NA	ALPINE AEROTECH.LP	L0171
9	1	>AAL-280-092-004	DOUBLER, DETAIL	NA	NA	NA	NA	ALPINE AEROTECH.LP	L0171
10	4	>MS20426AD3-3	RIVET, SOLID, COUNTERSUNK HEAD	SEE SPEC	SEE SPEC	NASM20426	SEE SPEC	SOURCE AS REQUIRED	NA
11	2	AAL-280-092-019	DZUS RAIL, DETAIL	ALUMINUM	NA	D5-PR35H319	CLEAN	ALPINE AEROTECH LP	L0171
12	1	AAL-280-091-003	CENTER DZUS RAIL, ASSY	NA	NA	NA	NA	ALPINE AEROTECH LP	L0171
13	2	>AAL-280-092-019	DZUS RAIL, DETAIL	ALUMINUM	NA	D5-PR35H319	CLEAN	ALPINE AEROTECH LP	L0171
14	2	>AAL-280-092-009	SHIM, DETAIL	NA	NA	NA	NA	ALPINE AEROTECH.LP	L0171
15	1	>AAL-280-092-010	SHIM, DETAIL	NA	NA	NA	NA	ALPINE AEROTECH.LP	L0171
16	24	>MS20470AD4-8-5	RIVET, SOLID, UNIVERSAL HEAD	SEE SPEC	SEE SPEC	NASM20470	SEE SPEC	SOURCE AS REQUIRED	NA
17	1	AAL-280-091-004	AFT ANGLE, ASSY	NA	NA	NA	NA	ALPINE AEROTECH LP	L0171
18	1	>AAL-280-092-005	AFT PEDESTAL PANEL, DETAIL	NA	NA	NA	NA	ALPINE AEROTECH.LP	L0171
19	1	>AAL-280-092-006	ANGLE, DETAIL	NA	NA	NA	NA	ALPINE AEROTECH.LP	L0171
20	13	>MS20470AD3-3-5	RIVET, SOLID, UNIVERSAL HEAD	SEE SPEC	SEE SPEC	NASM20470	SEE SPEC	SOURCE AS REQUIRED	NA
21	1	AAL-280-092-007	LHS ANGLE, DETAIL	NA	NA	NA	NA	ALPINE AEROTECH.LP	L0171
22	1	AAL-280-092-008	RHS ANGLE, DETAIL	NA	NA	NA	NA	ALPINE AEROTECH.LP	L0171
23	1	AAL-280-092-013	LHS AFT BRACKET, DETAIL	NA	NA	NA	NA	ALPINE AEROTECH.LP	L0171
24	1	AAL-280-092-014	RHS AFT BRACKET, DETAIL	NA	NA	NA	NA	ALPINE AEROTECH.LP	L0171
25	1	AAL-280-091-005	PANEL MOUNT PLATE, ASSY	NA	NA	NA	NA	ALPINE AEROTECH LP	L0171
26	1	>AAL-280-092-015	PANEL MOUNT>PLATE, DETAIL	NA	NA	NA	NA	ALPINE AEROTECH.LP	L0171
27	4	>50-018-1	FASTENER, PANEL, STUD, 1/4 TURN	SEE SPEC	SEE SPEC	MIL-F-25173	BLACK OXIDE	BHT	97499
28	4	AAL-280-092-016	ANGLE, DETAIL	NA	NA	NA	NA	ALPINE AEROTECH LP	L0171
29	1	L EXTRUSION, ALUMINUM	2" X 1" X .125" X 38.0" ANGLE, DETAIL	NA	NA	NA	NA	NA	NA
30	6	MS20470AD4-6-5	RIVET, SOLID, UNIVERSAL HEAD	SEE SPEC	SEE SPEC	NASM20470	SEE SPEC	SOURCE AS REQUIRED	NA
31	46	MS20470AD4-6	RIVET, SOLID, UNIVERSAL HEAD	SEE SPEC	SEE SPEC	NASM20470	SEE SPEC	SOURCE AS REQUIRED	NA
32	52	MS20470AD4-4	RIVET, SOLID, UNIVERSAL HEAD	SEE SPEC	SEE SPEC	NASM20470	SEE SPEC	SOURCE AS REQUIRED	NA
33	6	MS20470AD4-5	RIVET, SOLID, UNIVERSAL HEAD	SEE SPEC	SEE SPEC	NASM20470	SEE SPEC	SOURCE AS REQUIRED	NA
34	4	MS20470AD4-5-5	RIVET, SOLID, UNIVERSAL HEAD	SEE SPEC	SEE SPEC	NASM20470	SEE SPEC	SOURCE AS REQUIRED	NA
35	10	MS20470AD4-4-5	RIVET, SOLID, UNIVERSAL HEAD	SEE SPEC	SEE SPEC	NASM20470	SEE SPEC	SOURCE AS REQUIRED	NA
36	11	MS20470AD3-3-5	RIVET, SOLID, UNIVERSAL HEAD	SEE SPEC	SEE SPEC	NASM20470	SEE SPEC	SOURCE AS REQUIRED	NA

ITEM	QTY	NUMBER	DESCRIPTION	MATERIAL	REF STOCK SIZE	SPEC	FINISH	MANUFACTURER	NCAGEC
37	6	MS20470AD4-8-5	RIVET, SOLID, UNIVERSAL HEAD	SEE SPEC	SEE SPEC	NASM20470	SEE SPEC	SOURCE AS REQUIRED	NA
38	6	MS20470AD3-4	RIVET, SOLID, UNIVERSAL HEAD	SEE SPEC	SEE SPEC	NASM20470	SEE SPEC	SOURCE AS REQUIRED	NA
39	28	MS20426AD3-4	RIVET, SOLID, COUNTERSUNK HEAD	SEE SPEC	SEE SPEC	NASM20426	SEE SPEC	SOURCE AS REQUIRED	NA
40	50	MS20426AD3-5	RIVET, SOLID, COUNTERSUNK HEAD	SEE SPEC	SEE SPEC	NASM20426	SEE SPEC	SOURCE AS REQUIRED	NA
41	2	AAL-280-092-022	FILLER, DETAIL	NA	NA	NA	NA	ALPINE AEROTECH.LP	L0171
42	1	AAL-280-092-021	DRILL TEMPLATE, DETAIL	NA	NA	NA	NA	ALPINE AEROTECH LP	L0171
43	4	MS20426AD4-5	RIVET, SOLID, COUNTERSUNK HEAD	SEE SPEC	SEE SPEC	NASM20426	SEE SPEC	SOURCE AS REQUIRED	NA
44	1	AAL-280-092-020	FILLER, DETAIL	NA	NA	NA	NA	ALPINE AEROTECH LP	L0171
45	3	MS20426AD4-9	RIVET, SOLID, COUNTERSUNK HEAD	SEE SPEC	SEE SPEC	NASM20426	SEE SPEC	SOURCE AS REQUIRED	NA
46	14	50-018-1	FASTENER, PANEL, STUD, 1/4 TURN	SEE SPEC	SEE SPEC	MIL-F-25173	BLACK OXIDE	BHT	97499