

## CARGO MIRROR/PULSE LIGHT, KIT ILLUSTRATED PARTS BREAKDOWN

**MODELS: BELL 212**



## General Notes

1. Alternate items listed.
2. If changes to this document are required, Alpine Aerotech LP shall revise all pages and reissue the entire document.
3. Alpine Aerotech LP. shall make any subsequent revisions of this document available upon request. Alpine Aerotech LP. also recommends that the end user of this product periodically verify the revision level of this document.

 Not supplied, procure item locally.

 Not shown. See wiring diagram in Installation Instructions (AAL-290-015-006).

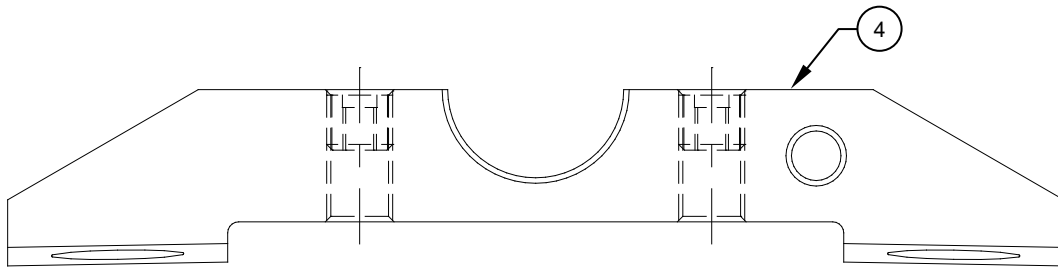
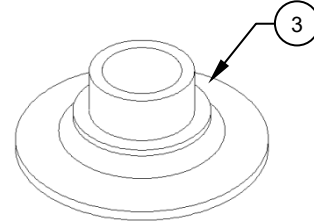
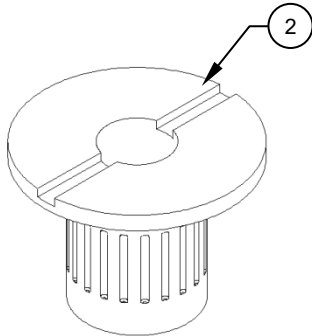

Mounting Block,  
Assy, LHS Shown

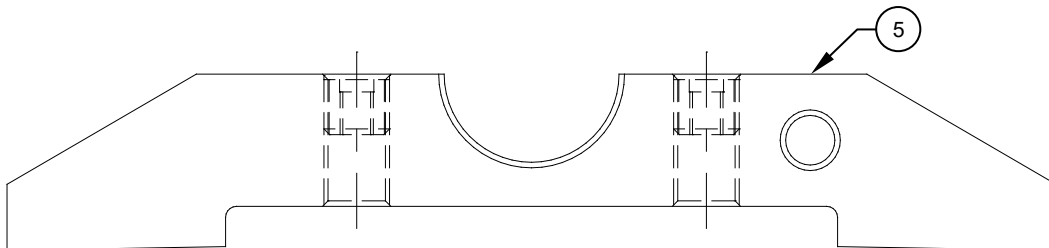

Mounting Block,  
Assy, RHS Shown

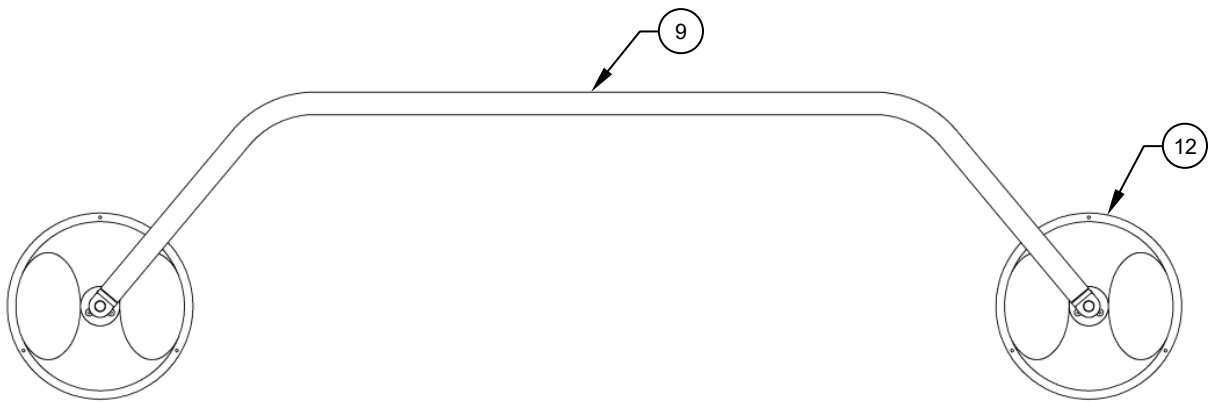
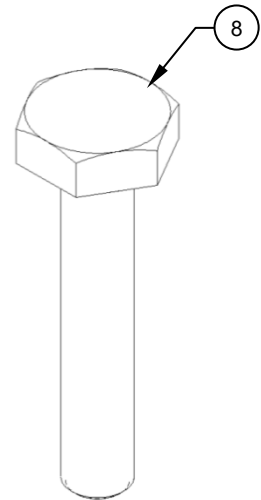
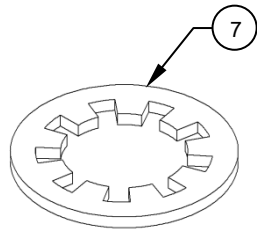
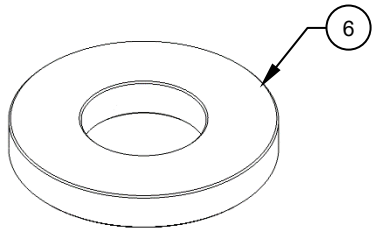

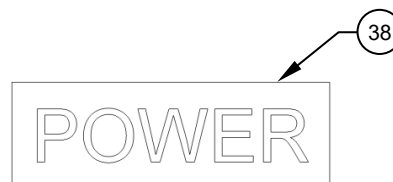
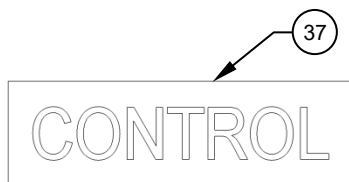
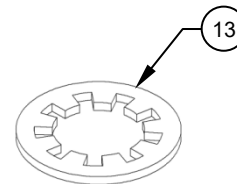
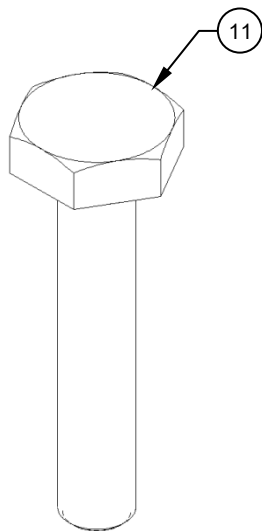
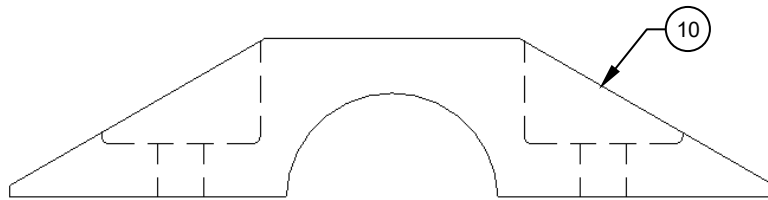

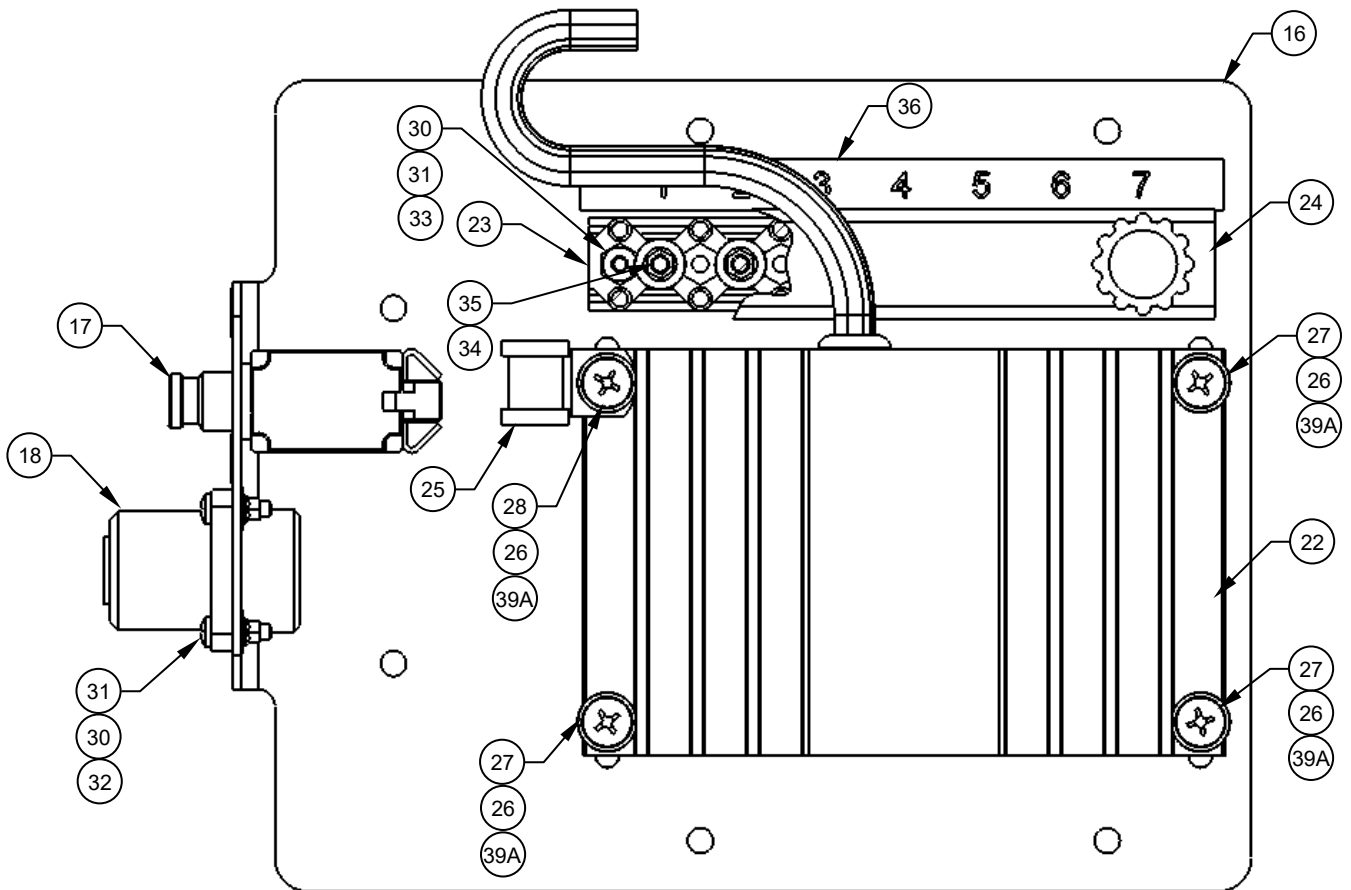

Control Unit, Assy  
Item 15  
Some items not shown for clarity

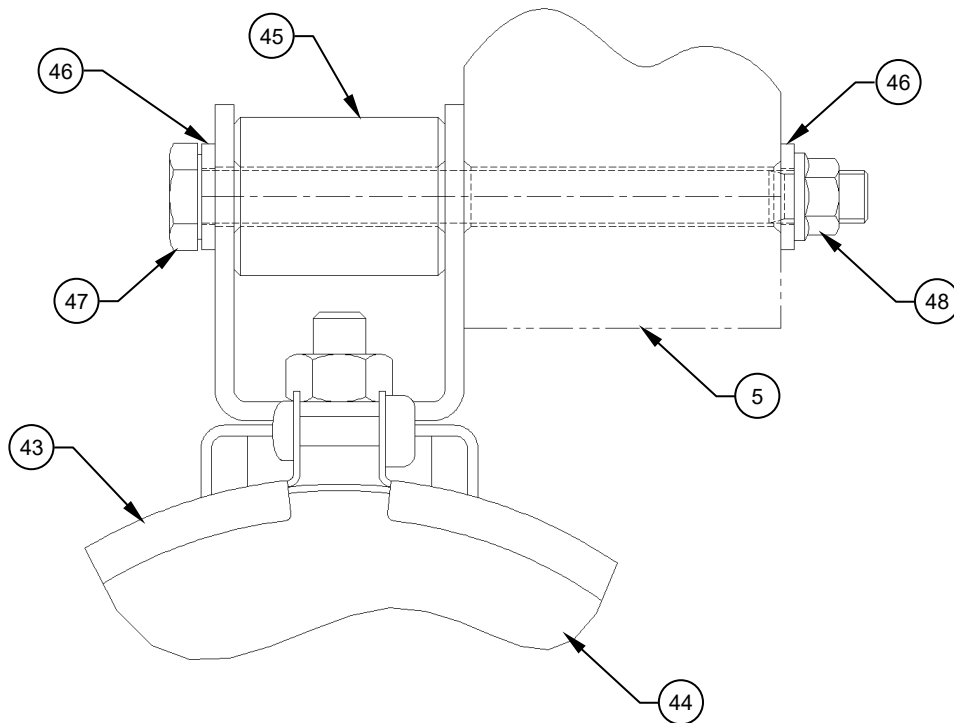
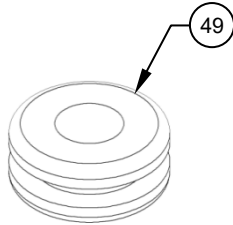

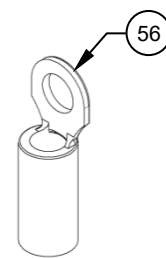
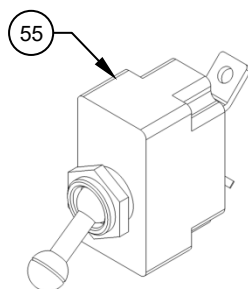
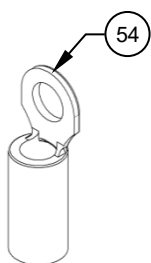
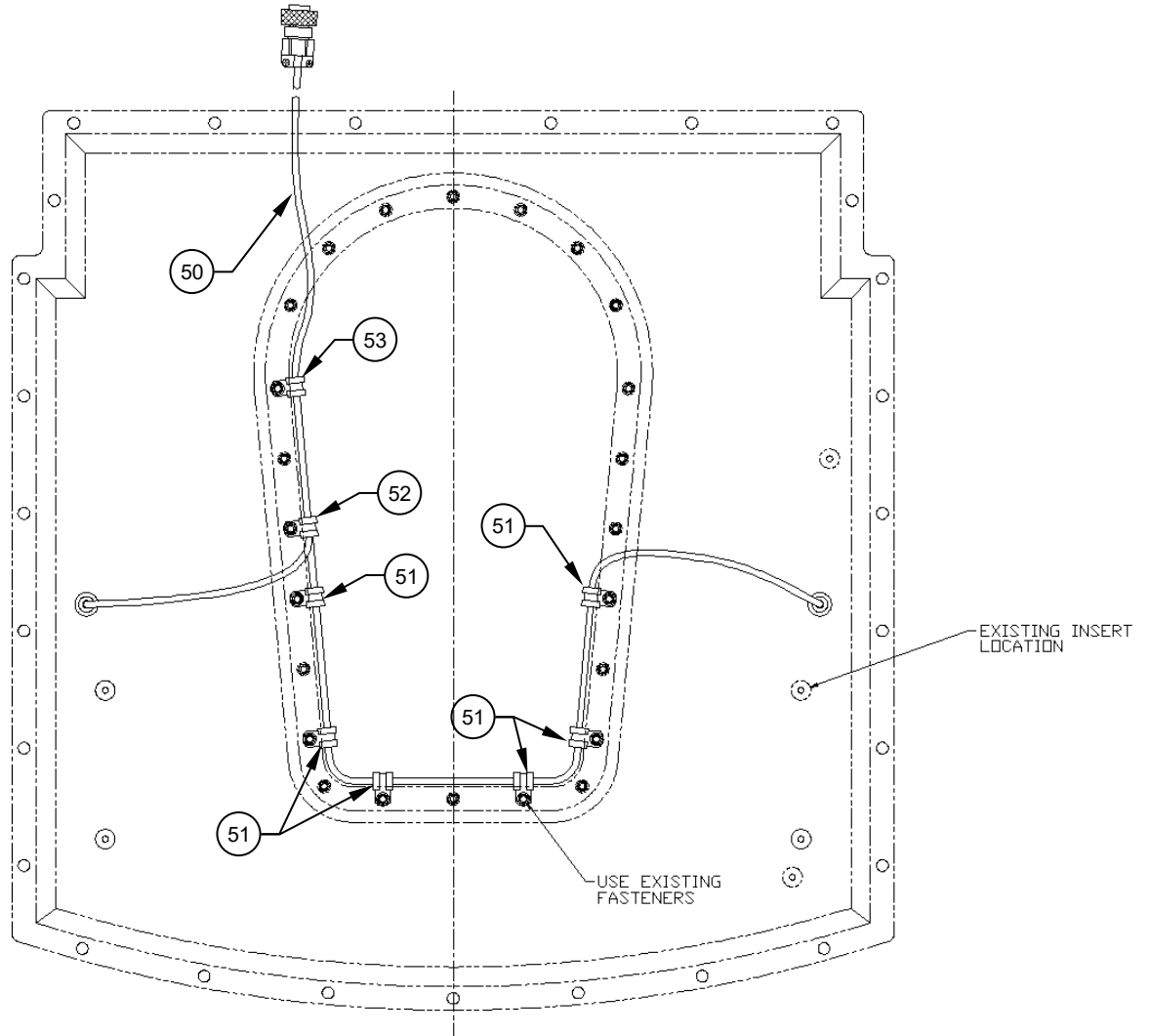



## Parts List - 212

ITEM	QTY	NUMBER	DESCRIPTION	MATERIAL	REF	SPEC	FINISH	MANUFACTURER	NCAGEC
-	-	AAL-706-103-003	212 CARGO MIRROR/PULSE LIGHT, KIT	C/O SHADED ITEMS ONLY					
1	1	AAL-706-103-001	CARGO MIRROR, KIT	NA	NA	NA	NA	ALPINE AEROTECH LTD.	L0171
2	3	>80-013-S3F08K-9	INSERT, SLEEVE	SEE MFR	SEE MFR	SEE MFR	SEE MFR	BELL HELICOPTER	97499
2	3	>SLS196FK1032-08	INSERT, SLEEVE	SEE MFR	SEE MFR	SEE MFR	SEE MFR	SHUR-LOK CORP.	98393
2	3	>TYES196F1032-08K	INSERT, SLEEVE	SEE MFR	SEE MFR	SEE MFR	SEE MFR	THE YOUNG ENGINEERS	56958
3	3	>80-013-P3D1-9	INSERT, PLUG	SEE MFR	SEE MFR	SEE MFR	SEE MFR	BELL HELICOPTER	97499
3	3	>P196D10-1	INSERT, PLUG	SEE MFR	SEE MFR	SEE MFR	SEE MFR	ALCOA GLOBAL FASTENERS INC.	83324
4	1	>AAL-290-011-001	MOUNTING BLOCK, ASSY, LHS	NA	NA	NA	NA	ALPINE AEROTECH LTD.	L0171
5	1	>AAL-290-011-002	MOUNTING BLOCK, ASSY, RHS	NA	NA	NA	NA	ALPINE AEROTECH LTD.	L0171
6	8	>NAS1149F0363P	WASHER, FLAT	SEE SPEC	SEE SPEC	NAS1149	SEE SPEC	SOURCE AS REQUIRED	NA
7	8	>MS35333-39	WASHER, LOCK	SEE SPEC	SEE SPEC	NASM35333	SEE SPEC	SOURCE AS REQUIRED	NA
8	4	>AN3-10A	BOLT, MACHINE	SEE SPEC	SEE SPEC	NASM3THRU20	SEE SPEC	SOURCE AS REQUIRED	NA
9	1	>AAL-290-011-005	CROSS TUBE, ASSY	SEE MFR	SEE MFR	SEE MFR	SEE MFR	ALPINE AEROTECH LTD.	L0171
10	2	>AAL-706-103-103	CAP, DETAIL	NA	NA	NA	NA	ALPINE AEROTECH LTD.	L0171
11	4	>AN3-6A	BOLT, MACHINE	SEE SPEC	SEE SPEC	NASM3THRU20	SEE SPEC	SOURCE AS REQUIRED	NA
12	2	>12182	MIRROR, ASSY	SEE MFR	SEE MFR	SEE MFR	SEE MFR	GROTE INDUSTRIES	NA
12	2	>12183	MIRROR, ASSY	SEE MFR	SEE MFR	SEE MFR	SEE MFR	GROTE INDUSTRIES	NA
13	2	>MS35333-40	WASHER, LOCK	SEE SPEC	SEE SPEC	NASM35333	SEE SPEC	SOURCE AS REQUIRED	NA
14	1	AAL-706-103-002	PULSE LIGHT, KIT	NA	NA	NA	NA	ALPINE AEROTECH LTD.	L0171
15	1	>AAL-290-011-013	CONTROL UNIT, ASSY	NA	NA	NA	NA	ALPINE AEROTECH LTD.	L0171
16	1	>>AAL-290-011-006	MOUNTING PLATE, ASSY	NA	NA	NA	NA	ALPINE AEROTECH LTD.	L0171
17	1	>>MS26574-3	CIRCUIT BREAKER, TRIP FREE, PUSH-PULL	SEE SPEC	SEE SPEC	AS26574	SEE SPEC	SOURCE AS REQUIRED	NA
17	1	>>7274-2-3	CIRCUIT BREAKER, TRIP FREE, PUSH-PULL	SEE SPEC	SEE SPEC	AS26574	SEE SPEC	TEXAS INSTRUMENTS INC.	82674

## Parts List - 212

ITEM	QTY	NUMBER	DESCRIPTION	MATERIAL	REF STOCK SIZE	SPEC	FINISH	MANUFACTURER	NCAGEC
18	1	>>AAL-290-011-007	WIRING HARNESS, ASSY	NA	NA	NA	NA	ALPINE AEROTECH LTD.	L0171
19	1	>>AAL-290-011-009	WIRING HARNESS, ASSY	NA	NA	NA	NA	ALPINE AEROTECH LTD.	L0171
19	1	>>AAL-290-011-010	WIRING HARNESS, ASSY	NA	NA	NA	NA	ALPINE AEROTECH LTD.	L0171
21	1	>>AAL-290-011-011	WIRING HARNESS, ASSY	NA	NA	NA	NA	ALPINE AEROTECH LTD.	L0171
22	1	>>AAL-290-011-012	PULSELIGHT MODULE, ASSY	NA	NA	NA	NA	ALPINE AEROTECH LTD.	L0171
23	1	>>MS27212-1-7	TERMINAL BOARD, ASSY	SEE SPEC	SEE SPEC	AS27212	SEE SPEC	SOURCE AS REQUIRED	NA
24	1	>>MS18029-1S-7	COVER, ASSY	SEE SPEC	SEE SPEC	MS18029	SEE SPEC	SOURCE AS REQUIRED	NA
25	1	>>AS21919WDG02	CLAMP, LOOP TYPE, CUSHIONED, SUPPORT	SEE SPEC	SEE SPEC	AS21919	SEE SPEC	SOURCE AS REQUIRED	NA
26	4	>>NAS1149F0332P	WASHER, FLAT	SEE SPEC	SEE SPEC	NAS1149	SEE SPEC	SOURCE AS REQUIRED	NA
27	3	>>MS27039-1-12	SCREW, MACHINE	SEE SPEC	SEE SPEC	NASM27039	SEE SPEC	SOURCE AS REQUIRED	NA
28	1	>>MS27039-1-13	SCREW, MACHINE	SEE SPEC	SEE SPEC	NASM27040	SEE SPEC	SOURCE AS REQUIRED	NA
29	-	-	<b>ITEM NUMBER NOT USED</b>	-	-	-	-	-	-
30	6	>>NAS1149FN416P	WASHER, FLAT	SEE SPEC	SEE SPEC		SEE SPEC	SOURCE AS REQUIRED	NA
31	6	>>MS35206-215	SCREW, MACHINE, PAN- HEAD	SEE SPEC	SEE SPEC	NASM35206	SEE SPEC	SOURCE AS REQUIRED	NA
32	4	>>MS21043-04	NUT, SELF LOCKING	SEE SPEC	SEE SPEC	NASM21043	SEE SPEC	SOURCE AS REQUIRED	NA
33	2	>>MS21044-N04	NUT, SELF LOCKING	SEE SPEC	SEE SPEC	NASM21044	SEE SPEC	SOURCE AS REQUIRED	NA
34	14	>>NAS1149FN632P	WASHER, FLAT	SEE SPEC	SEE SPEC	NAS1149	SEE SPEC	SOURCE AS REQUIRED	NA
35	7	>>MS21043-06	NUT, SELF LOCKING	SEE SPEC	SEE SPEC	NASM21043	SEE SPEC	SOURCE AS REQUIRED	NA
36	1	>>AAL-706-103-242	DECAL, DETAIL	NA	NA	NA	NA	ALPINE AEROTECH LTD.	L0171
37	1	>>AAL-706-103-243	DECAL, DETAIL	NA	NA	NA	NA	ALPINE AEROTECH LTD.	L0171
38	1	>>AAL-706-103-244	DECAL, DETAIL	NA	NA	NA	NA	ALPINE AEROTECH LTD.	L0171
39	AR	>>MS3367-()-9	STRAP, TIE-DOWN, ELECTRICAL	SEE SPEC	SEE SPEC	AS33671	SEE SPEC	SOURCE AS REQUIRED	L0171
39A	4	>>NAS42DD6-20N	SPACER	SEE SPEC	SEE SPEC	NAS42	SEE SPEC	SOURCE AS REQUIRED	NA
40	-	-	<b>ITEM NUMBER NOT USED</b>	-	-	-	-	-	-
41	-	-	<b>ITEM NUMBER NOT USED</b>	-	-	-	-	-	-
42	-	-	<b>ITEM NUMBER NOT USED</b>	-	-	-	-	-	-
43	2	>01-0770155-00	HOUSING, ASSY	A715-1	SEE MFR	SEE MFR	SEE MFR	WHELEN ENGINEERING COMPANY INC.	10402

## Parts List - 212

ITEM	QTY	NUMBER	DESCRIPTION	MATERIAL	REF STOCK SIZE	SPEC	FINISH	MANUFACTURER	NCAGEC	
44	2	>01-0771833-25	LAMP, ASSY	SEE MFR	PAR-36 LED	SEE MFR	SEE MFR	WHELEN ENGINEERING COMPANY INC.	10402	
45	2	>AAL-706-103-203	SPACER, DETAIL	NA	.750 OD	NA	SEE SPEC	ALPINE AEROTECH LTD.	L0171	
46	4	>NAS1149F0463P	WASHER, FLAT	SEE SPEC	SEE SPEC	NAS1149	SEE SPEC	SOURCE AS REQUIRED	NA	
47	2	>AN4-31A	BOLT, MACHINE	SEE SPEC	SEE SPEC	NASM3THRU20	SEE SPEC	SOURCE AS REQUIRED	NA	
48	2	>NAS9926-4L	NUT, SELF LOCKING	SEE SPEC	SEE SPEC	NAS9926	SEE SPEC	SOURCE AS REQUIRED	NA	
49	2	>MS35489-4	GROMMET	SEE SPEC	SEE SPEC	MS35489	SEE SPEC	SOURCE AS REQUIRED	NA	
50	1	>AAL-290-011-008	WIRING HARNESS, ASSY	NA	NA	NA	NA	ALPINE AEROTECH LTD.	NA	
51	6	>AS21919DG01	CLAMP, LOOP TYPE, CUSHIONED, SUPPORT	SEE SPEC	SEE SPEC	AS21919	SEE SPEC	SOURCE AS REQUIRED	NA	
52	1	>AS21919WDG02	CLAMP, LOOP TYPE, CUSHIONED, SUPPORT	SEE SPEC	SEE SPEC	AS21920	SEE SPEC	SOURCE AS REQUIRED	NA	
53	1	>AS21919WDG03	CLAMP, LOOP TYPE, CUSHIONED, SUPPORT	SEE SPEC	SEE SPEC	AS21921	SEE SPEC	SOURCE AS REQUIRED	NA	
54	4	>36152	TERMINAL, RING TONGUE, PIDG	SEE MFR	SEE MFR	SEE MFR	SEE MFR	TYCO ELECTRONICS	00779	
55	1	>7270-1-3	CIRCUIT BREAKER, AIRCRAFT, TRIP-FREE	SEE SPEC	SEE SPEC	AS58091	SEE SPEC	TEXAS INSTRUMENTS INC.	83647	
56	2	>35149	TERMINAL, RING TONGUE, PIDG	SEE MFR	SEE MFR	SEE MFR	SEE MFR	TYCO ELECTRONICS	00779	
△	C01	AR	NA	ADHESIVE	MAGNOBOND 6398	SEE MFR	SEE MFR	NA	MAGNOLIA PLASTICS INC.	22121
△	C02	AR	NA	SEALANT, FUEL TANK	PS 890, CLASS B	SEE MFR	AMS-S-8802	NA	PRC- DESOTO INTERNATIONAL	83574
△	C02	AR	NA	SEALANT, FUEL TANK	CS 3204, CLASS B	SEE MFR	AMS-S-8802	NA	FLAMEMASTER CORPORATION	14439